

WETLAND INFORMATION

ITEM #	ITEM	AREA
1	WETLAND AREA ON SITE	128,494 S.F.
2	WETLAND UPLAND REVIEW AREA ON SITE	367,750 S.F.
3	TEMPORARY DISTURBANCE WITHIN UPLAND REVIEW AREA	81,975 S.F.
4	PERMANENT DISTURBANCE WITHIN UPLAND REVIEW AREA	82,828 S.F.
5	TEMPORARY DISTURBANCE WITHIN WETLAND	0 S.F.
6	PERMANENT DISTURBANCE WITHIN WETLAND	0 S.F.

EARTHWORK VOLUME

	CUT (CY)	FILL (CY)	NET (CY)
UPLAND REVIEW AREA	9,450 CY	9,250 CY	200 CY CUT
TOTAL EARTHWORK ON SITE	20,000 CY	23,800 CY	3,800 CY FILL

WETLAND ACTIVITY PLAN LEGEND

	PROPERTY LINE
	PROPOSED RELOCATION OF EVERSOURCE EASEMENT TO BE COORDINATED WITH EVERSOURCE
	LIMIT OF DISTURBANCE
	FEMA LINE
	SAWCUT LINE
	WETLAND LINE
	AQUIFER PROTECTION ZONE LINE
	APPROXIMATE AREA TO BE FILLED WITHIN UPLAND REVIEW AREA
	ACTIVITIES WITHIN UPLAND REVIEW AREA

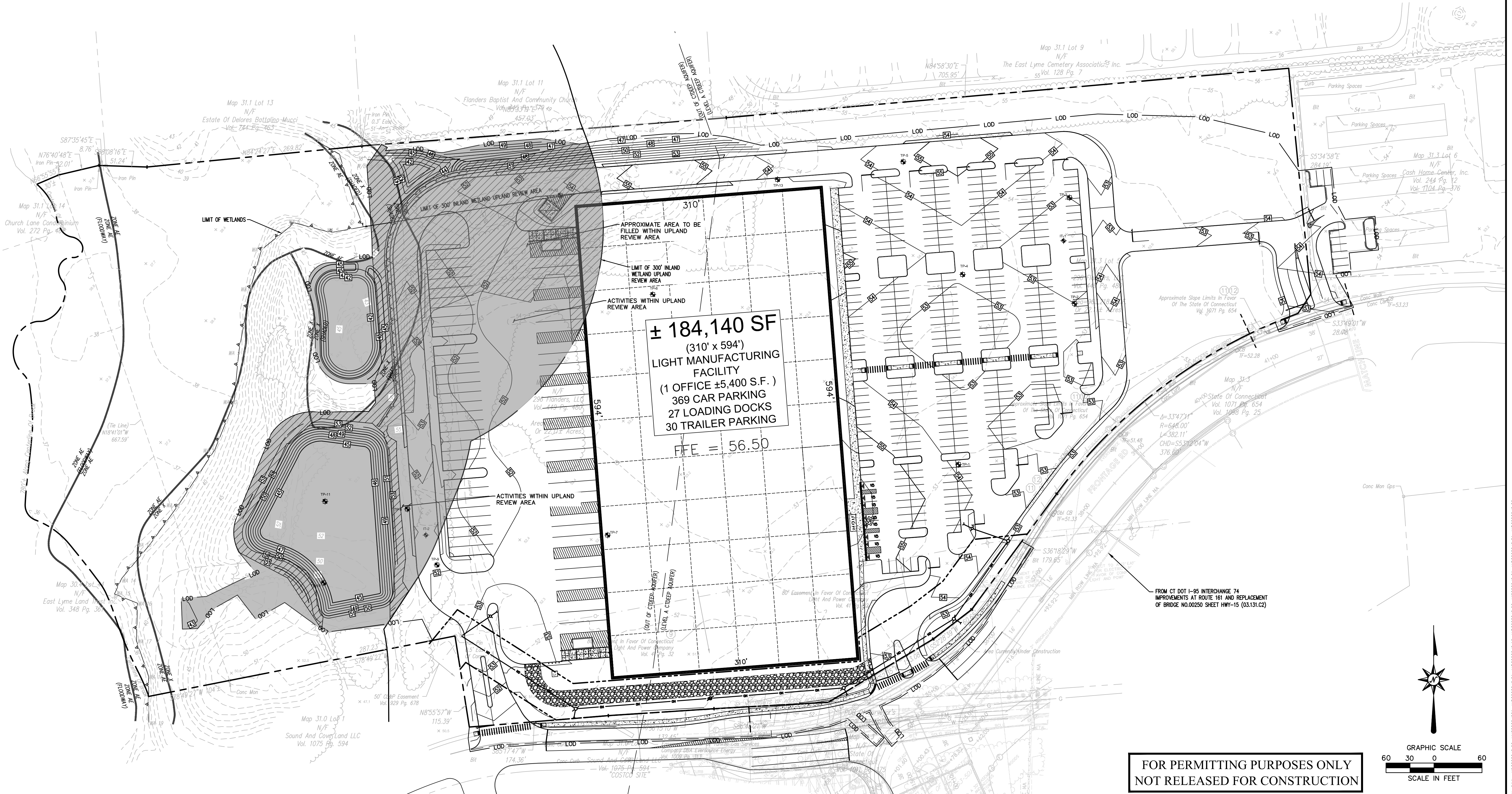

± 184,140 SF
 (310' x 594')
 LIGHT MANUFACTURING FACILITY
 (1 OFFICE ±5,400 S.F.)
 369 CAR PARKING
 27 LOADING DOCKS
 30 TRAILER PARKING
 FFE = 56.50

FOR PERMITTING PURPOSES ONLY
 NOT RELEASED FOR CONSTRUCTION

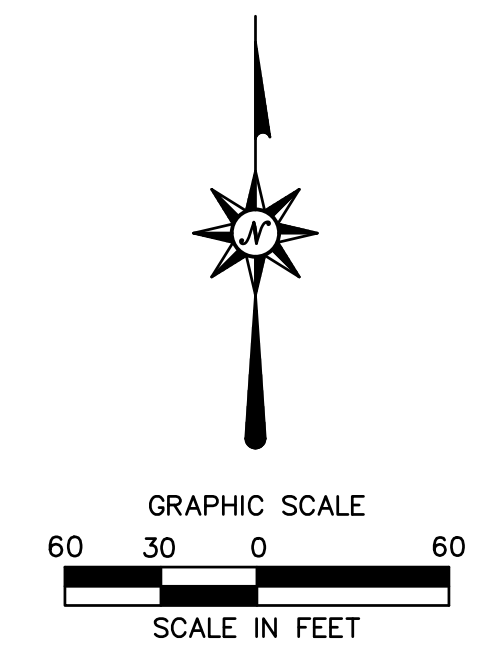

PROPOSED LIGHT MANUFACTURING
 296 FLANDERS ROAD
 EAST LYME, CONNECTICUT



100 Constitution Plaza
 10th Floor
 Hartford, CT 06103
 (860) 249-2200



DESIGNED: T.L.B.
 DRAWN: T.L.B.
 REVIEWED: R.M.R.
 SCALE: 1"=60'
 PROJECT NO.: 2302349
 DATE: 6/17/2024
 CAD FILE: WAP2302349-10
 TITLE: WETLAND ACTIVITY PLAN
 SHEET NO.: WAP1.00

6/17/2024, 10:46:41 AM, C:\Users\blc\OneDrive\Documents\WAP2302349-10.DWG, WAP1.00, 24x36, 60%.

© 2024 BL COMPANIES, INC. THESE DRAWINGS SHALL NOT BE UTILIZED BY ANY PERSON, FIRM OR CORPORATION WITHOUT THE SPECIFIC WRITTEN PERMISSION OF BL COMPANIES.