

RECEIVED FOR RECORD  
EAST LYME, CT  
2024 JUN -3 P 12:06  
COUNCILMAN  
TOWN CLERK

## EAST LYME POLICE COMMISSION GOLF CART REGULATIONS

(A) Pursuant to the provisions of Conn. Gen. Stat. § 14-300g, as amended, the Police Commission, acting herein as the duly constituted traffic authority of the town, hereby permits the operation of golf carts within the town in accordance with the terms of this regulation.

(B) Gas or electric powered golf carts permitted on town roads must be equipped with a minimum of four wheels, capable of a maximum speed of no more than 25 miles per hour, capable of transporting no more than four persons and comply with the following standards:

(1) Equipped with a locking brake, main power switch, head lamp(s), tail/brake lamps, operable horn as defined in Conn. Gen. Stat. § 14-80(e), rear view mirror and seatbelts/passenger safety restraints for rear-facing passengers.

(2) A flag with a minimum height of 72 inches from the ground and at least one foot above any installed roof shall be placed on the left rear of the golf cart to assist pedestrians and motor vehicle operators in observing the location and operation of a golf cart.

(3) A valid registration sticker from the Police Department placed in a visible location on the rear of the golf cart.

(C) Prior to operation of a golf cart the owner shall register it with the Police Department. The Police Department shall prepare a registration form and registration sticker for the registration of golf carts. The registration shall expire on May 31 of each calendar year. The owner of a golf cart shall at all times meet the following standards to obtain and maintain a valid golf cart registration.

(1) The owner must submit proof of ownership, such as a certificate of title or bill of sale, and a certificate of insurance covering the golf cart that meets the State of Connecticut minimum liability insurance requirements for a motor vehicle or insurance requirements that are established by the Connecticut Department of Motor Vehicle Regulations concerning golf carts upon adoption of same.

(2) The golf cart must satisfy the standards of division (B) above.

(3) The payment of a fee in the amount of \$35 is due for each registration period. From time to time the Police Commission may amend the amount of such fee to an amount sufficient to cover all costs associated with the implementation and enforcement of the requirements of this regulation.

(D) The following conditions shall apply to the operation of a golf cart:

(1) Operators must possess a valid Connecticut motor vehicle operator's license, proof of insurance and a valid golf cart registration.

(2) All applicable Connecticut and local laws and regulations governing the operation of a motor vehicle, including but not limited to parking rules and regulations, are applicable to the operation of a golf cart.

(3) Operation of a golf cart shall be permitted only between one-half hour after sunrise and one-half hour prior to sunset.

(4) Passengers shall be limited to one passenger per seat, with no more than four passengers in a golf cart.

(E) Golf carts may be operated only on those roads delineated on the maps/plans attached hereto as **Exhibits A-D** and which are located in the following areas of the town:

(1) The Oak Grove and Attawan Beach communities, those roads delineated on the map/plan attached as **Exhibit A**.

(2) The Black Point Beach Club Association, Inc. and The Old Black Point communities, those roads delineated on the map/plan attached as **Exhibit B**.

(3) The Saunders Point community, those roads delineated on the map/plan attached as **Exhibit C**.

(4) The Giants Neck Heights Community, those roads delineated on the map/plan attached as **Exhibit D**.

(F) The maps/plans attached as **Exhibits A-D** of Subsection (E) herein shall be filed with the Town Clerk and posted on the Town's website at [www.eltownhall.com](http://www.eltownhall.com)., and copies thereof available to members of the public.

(G) Any person who operates a golf cart in violation of any provision of Conn. Gen. Stat. § 14-300g(a), any insurance requirement established in accordance with Conn. Gen. Stat. § 14-300g(b) or any conditions or limitations established by the Police Commission for the operation of golf carts, shall have committed an infraction and will be subject to the same

# Exhibit A

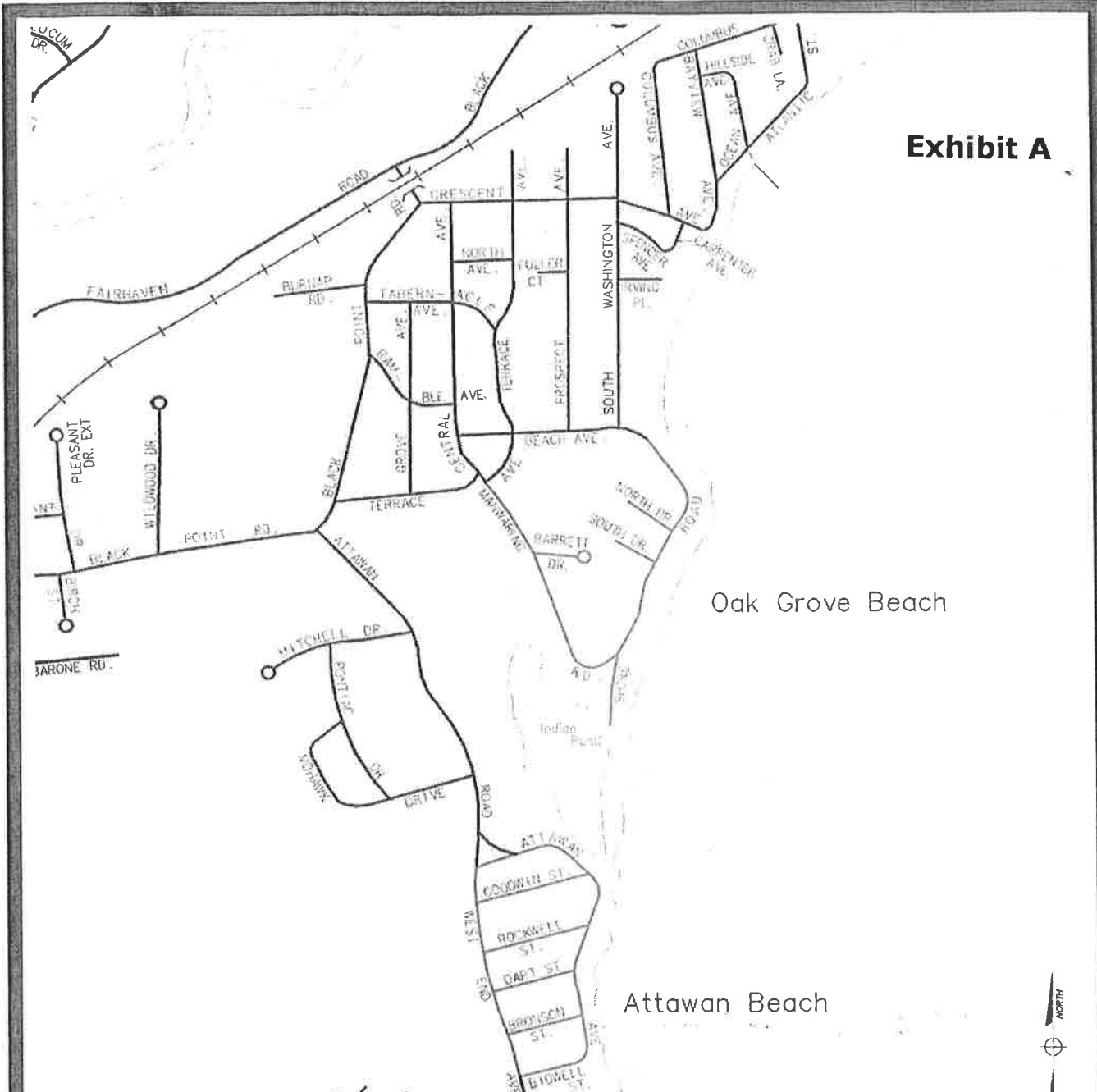

Oak Grove Beach

Attawan Beach



LTA APPROVAL DATE: *5/31/24*  
 CHAIR NAME: *Dan Piel*  
 CHAIR SIGNATURE: *[Handwritten Signature]*

## ROADWAY LEGEND

- GOLF CARTS ALLOWED
- GOLF CARTS NOT ALLOWED

PREPARED BY  
**THE EAST LYME  
 ENGINEERING DEPARTMENT**

## GOLF CART PERMITTED ROADS OAK GROVE BEACH AND ATTAWAN BEACH COMMUNITIES EAST LYME, CONNECTICUT

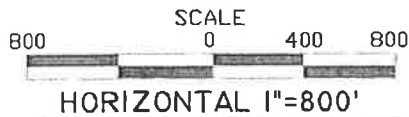

Date:	Drawn By:	Checked By:	Dwg. No.:	Sheet No.:
MAY 2024	AK	-	-	1 OF 1

Date: MARCH 2023	By: ATK	Checked: -	Dwg. No: -	Sheet No: 1 OF 1
------------------	---------	------------	------------	------------------

HORIZONTAL 1"=800'  
 SCALE  
 800 400 0 400 800

GOLF CART PERMITTED ROADS  
 BLACK POINT BEACH CLUB AND  
 OLD BLACK POINT COMMUNITIES  
 EAST LYME, CONNECTICUT

PREPARED BY  
 THE EAST LYME  
 ENGINEERING DEPARTMENT

ROADWAY LEGEND  
 GOLF CARTS ALLOWED  
 GOLF CARTS NOT ALLOWED

CHAIR NAME: Daniel Price  
 CHAIR SIGNATURE: *[Signature]*

LTA APPROVAL DATE: June 8, 2023

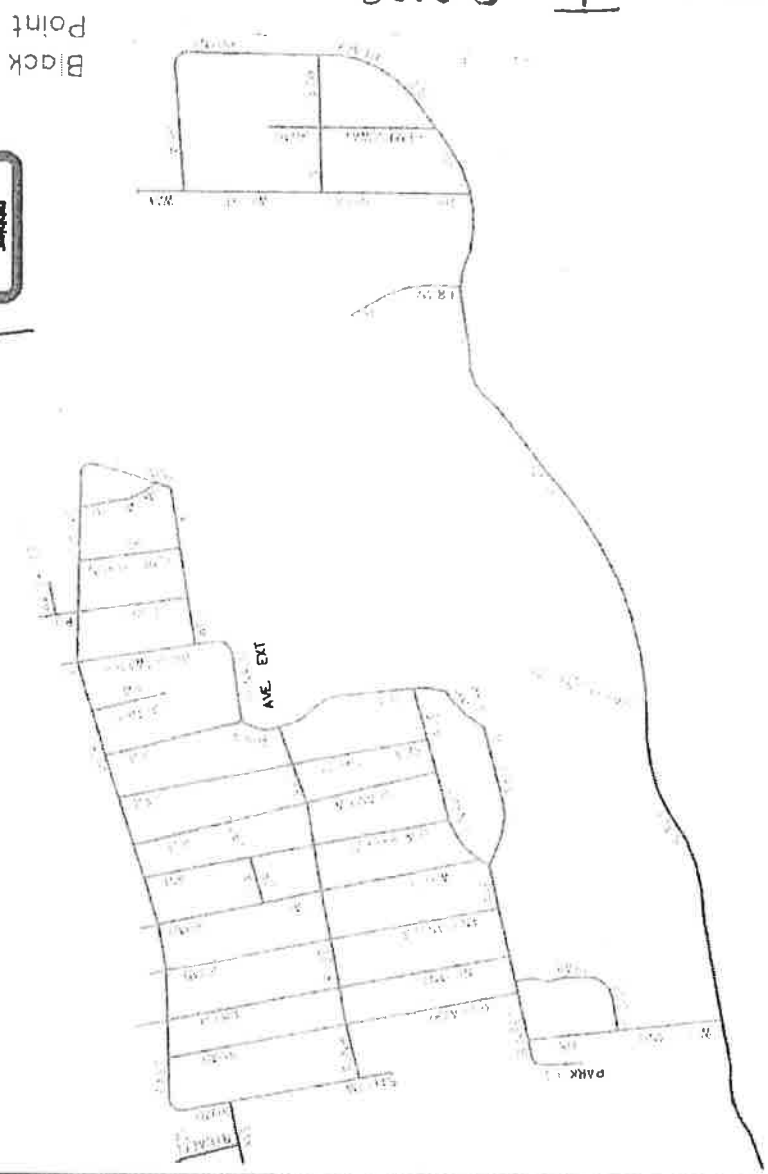
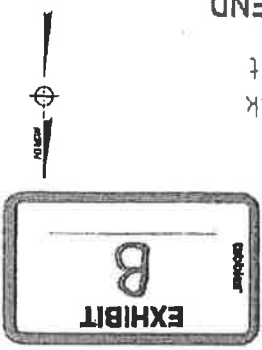

Black Point

EXHIBIT  
C

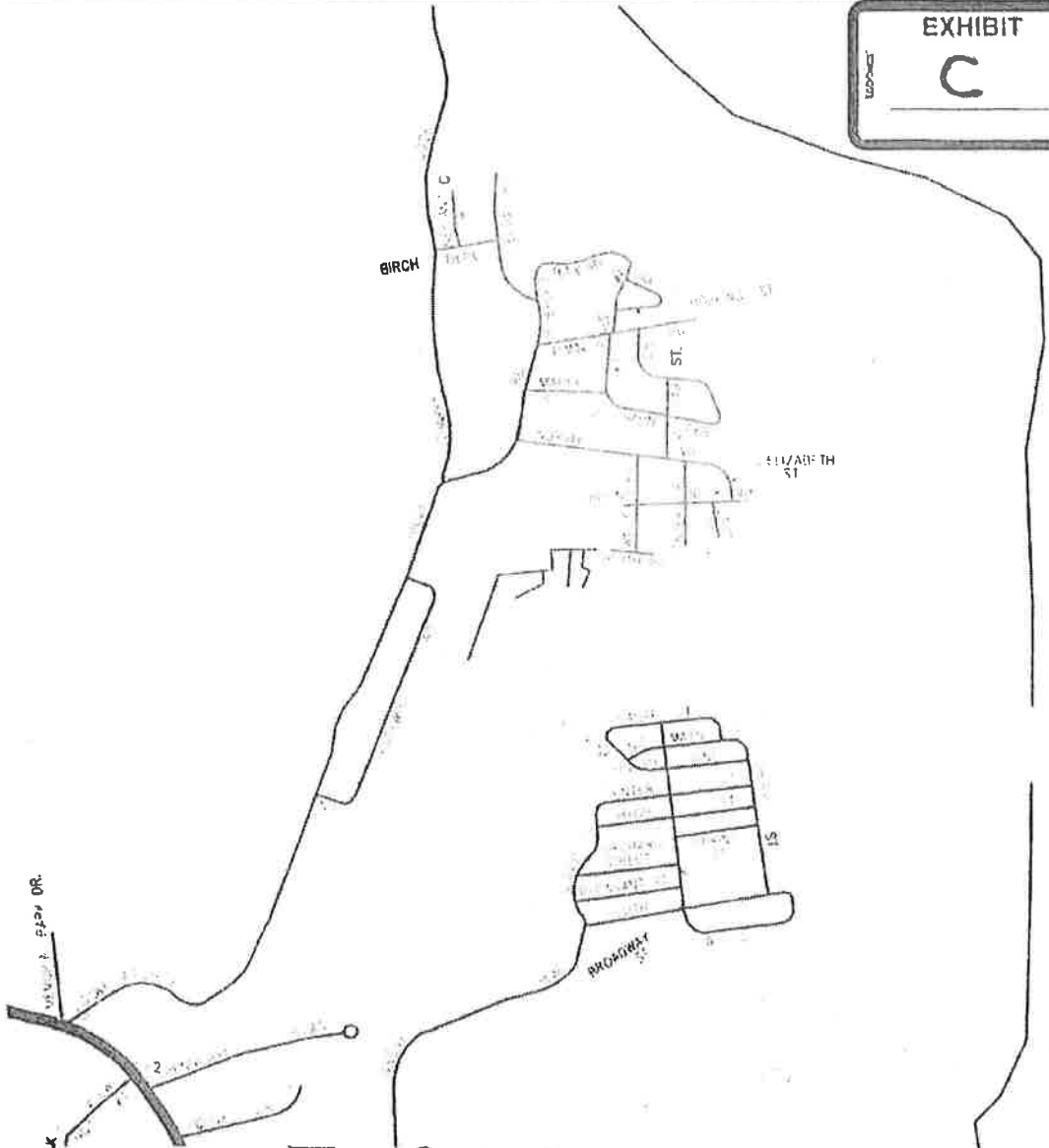

LTA APPROVAL DATE: June 8, 2023  
 CHAIR NAME: Daniel Price  
 CHAIR SIGNATURE: *[Signature]*

**ROADWAY LEGEND**  
 ——— GOLF CARTS ALLOWED  
 ——— GOLF CARTS NOT ALLOWED

PREPARED BY  
 THE EAST LYME  
 ENGINEERING DEPARTMENT

**GOLF CART PERMITTED ROADS**  
 SAUNDERS POINT COMMUNITY  
 EAST LYME, CONNECTICUT

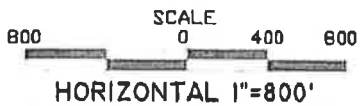

Date: MARCH 2023	Drawn By: AK	Checked By:	Dwg. No.:	Sheet No.:
				1 OF 1

# Exhibit D



GOLF CARTS ARE AUTHORIZED TO USE THE GIANT'S NECK HEIGHTS BEACH TURNAROUND, BUT THEN MUST BE PARKED IN AN APPROPRIATE LOCATION.

LTA APPROVAL DATE: 5/31/24

CHAIR NAME: Don Pice

CHAIR SIGNATURE: [Signature]

## ROADWAY LEGEND

- GOLF CARTS ALLOWED
- GOLF CARTS NOT ALLOWED

PREPARED BY  
**THE EAST LYME  
 ENGINEERING DEPARTMENT**

## GOLF CART PERMITTED ROADS GIANTS NECK HEIGHTS COMMUNITY EAST LYME, CONNECTICUT

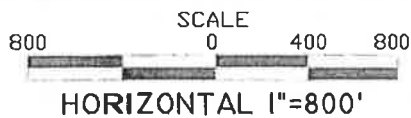

Date: MAY 2024	Drawn By: AK	Checked By: -	Dwg. No.: -	Sheet No.: 1 OF 1
-------------------	-----------------	------------------	----------------	----------------------