

NOTE:
 1) Property owner will be responsible for maintenance and repair of water service, septic systems, private roads, including but not limited to, snow plowing, street lights and pedestrian internal access improvements.

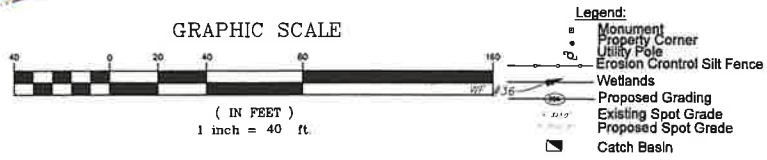

Received
 APR 24 2024
 Town of East Lyme
 Land Use

May Engineering LLC
 Civil Engineering and Site Planning
 1297 RT 163 Oakdale, CT 06370
 860 884-9671

CONCEPTUAL SITE PLAN
 AGE RESTRICTED RENTAL HOUSING
 PER C.G.S. 8-30g
 91 Boston Post Road
 East Lyme, Connecticut

DESCRIPTION:
 FEASIBILITY & LAYOUT PLAN

SCALE: 1' = 40'
 DATE: 22 April 2024

JOB NUMBER	SHEET
	1 of 1