



Town of East Lyme
 Zoning Department
 PO Box 519
 Niantic, CT 06357
 (860) 691-4114
 FAX: (860) 691-0351

SPECIAL PERMIT APPLICATION

Location: Zavala Mexican Bistro Date of Application: 04/07/22

Assessor's Map/Block/Lot: _____ Zone: _____

Applicant's Name: Martin C. Zavala zavalamexicanbistro@gmail.com

Applicant's Address: 135 Boston Post Rd Telephone: 860 691-1200

Owner of Record: Village Farm Realty LLC Volume/Page: _____

Owner's Address: 357 Delano Dr, North Kingstown, RI 02852 Telephone: 860 961 3555

DESCRIPTION OF SPECIAL PERMIT REQUEST {Requires compliance with Zoning Regulations 24, 25 & 9 and all other applicable Zoning Regulations of the Town of East Lyme; also state which sections of Zoning Regulations Special Permit is subject to}:

the patio shall close at 9:00pm during the week and 10pm on the weekend

Signature of Owner: _____

Signature of Applicant: Martin C. Zavala

Attach a true copy of the Deed and a Site Plan {10 copies required}. A copy of the deeds for all affected properties and a site plan demonstrating compliance with all applicable zoning code requirements must accompany this application.

Proof of posting of Special Permit Application public notice sign (Section 25.4.3-1). Proof of posting of the Special Permit Application for Public Notice must be submitted.

Below this line for Office Use Only:

Deed Copies Attached: YES NO	SPECIAL PERMIT FEE	\$150.00
	OUTDOOR DINING RENEWAL	\$20.00
Site Plan Attached: YES NO N/A	SITE PLAN FEE	\$300.00
	STORM WATER	\$300.00
CHECK #: _____	STATE FEE:	\$60.00
	TOTAL DUE:	\$ 80.00

Date Approved: _____ Date Denied: _____

Approval subject to conditions attached. YES/NO

Approval to become effective upon publication and date of entry into the land records of the Town of East Lyme affecting the premises as described in this application.

Date: _____ Attest _____

East Lyme Zoning Chairman

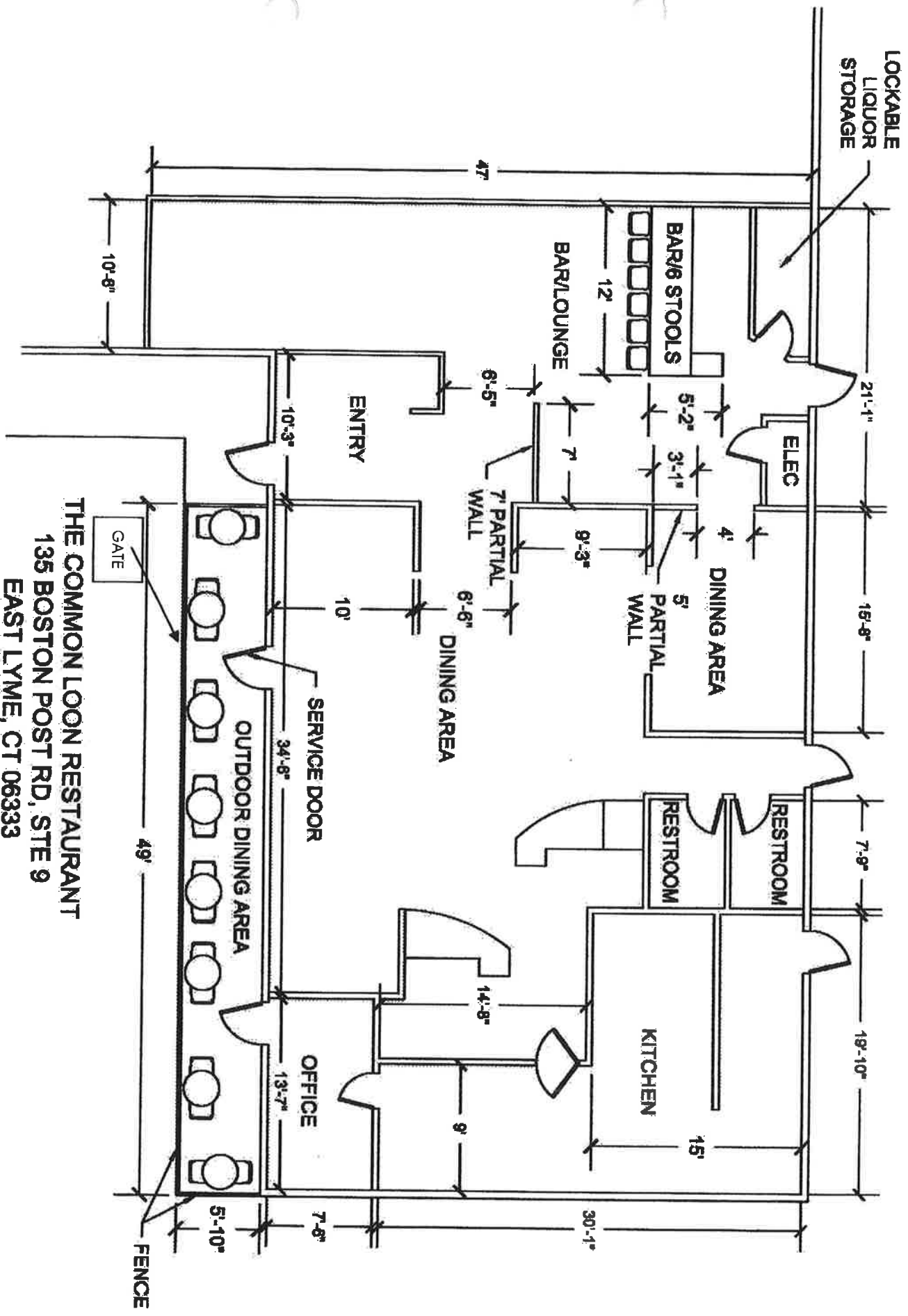

THE COMMON LOON RESTAURANT
 135 BOSTON POST RD, STE 9
 EAST LYME, CT 06333