

Town of East Lyme

APPLICATION FOR SPECIAL PERMIT

Date of Application: February 18, 2022 Zone: _____

Applicant's Name: Scott O'Reilly, Owner, East Lyme Café, LLC dba Smokey O'Grady's

Applicant's Address: 306 Flanders Road East Lyme, CT 06333 Telephone: (860)

Location of Affected Premises: 306 Flanders Road Assessor's Map/Block/Lot: 31.3/7

Owner of Record: HW Properties LLC Volume/Page: 816/298

Owner's Address: 565 Coleman Street, New London, CT Telephone: _____

DESCRIPTION OF SPECIAL PERMIT REQUESTED *{Requires compliance with Zoning Regulations 24, 25 & 9 and all other applicable Zoning Regulations of the Town of East Lyme; also state which sections of Zoning Regulations Special Permit is subject to}*:

Renewal of Special Permit Application for Outdoor Dining at the above referenced premises with the following previously approved conditions:

1. Entertainment will be allowed with acoustic guitar without amplification and a low level amplifier for the microphone only. Entertainment will be allowed until 10:00 p.m.;
2. Service will be from 11:00 a.m. to 11:00 p.m., the last seating will be allowed at 10:00 p.m. All service shall cease at 11:00 p.m.;
3. Upon request of the East Lyme Cemetery Association, any entertainment outside will be halted for burial services;
4. There are to be 9 fixed seats around the service counter and 5 fixed seats around the tabletop and that will be serviced by wait staff;

Signature of Owner/Applicant: _____

Attach a true copy of the Deed and a Site Plan {10 copies required}. A copy of the deeds for all affected properties and a site plan demonstrating compliance with all applicable zoning code requirements must accompany this application.

Proof of posting of Special Permit Application public notice sign (Section 25.4.3-1). Proof of posting of the Special Permit Application for Public Notice must be submitted.

Below this line for Office Use Only:

Deed Copies Attached: YES NO	PERMIT FEE: SPECIAL PERMIT FEE	\$150.00	_____
	OUTDOOR DINING RENEWAL	\$20.00	20.00_
Site Plan Attached: YES NO N/A	SITE PLAN FEE	\$200.00	_____
	STORM WATER	\$200.00	_____
	STATE FEE:		\$60.00
CHECK #: <u>198</u>	TOTAL DUE:		\$ <u>80.00</u>

Date Approved: _____ Date Denied: _____

Approval subject to conditions below:

1. _____
2. _____

Approval to become effective upon publication and date of entry into the land records of the Town of East Lyme affecting the premises as described in this application.

Date: _____ Attest _____
East Lyme Zoning Chairman

306 Flanders Road, Smokey O'Grady's

UNDER BAR EQUIPMENT

- HAND SINK ----- SINKS WITH CHALLENGER SS-15-14
- 3 BAY SINK ----- SINKS WITH CHALLENGER SS-15-14
- ICE BIN ----- SINKS WITH CHALLENGER SS-15-14
- ICE BIN ----- SINKS WITH CHALLENGER SS-15-14
- ICE BIN ----- SINKS WITH CHALLENGER SS-15-14

Exh # 1

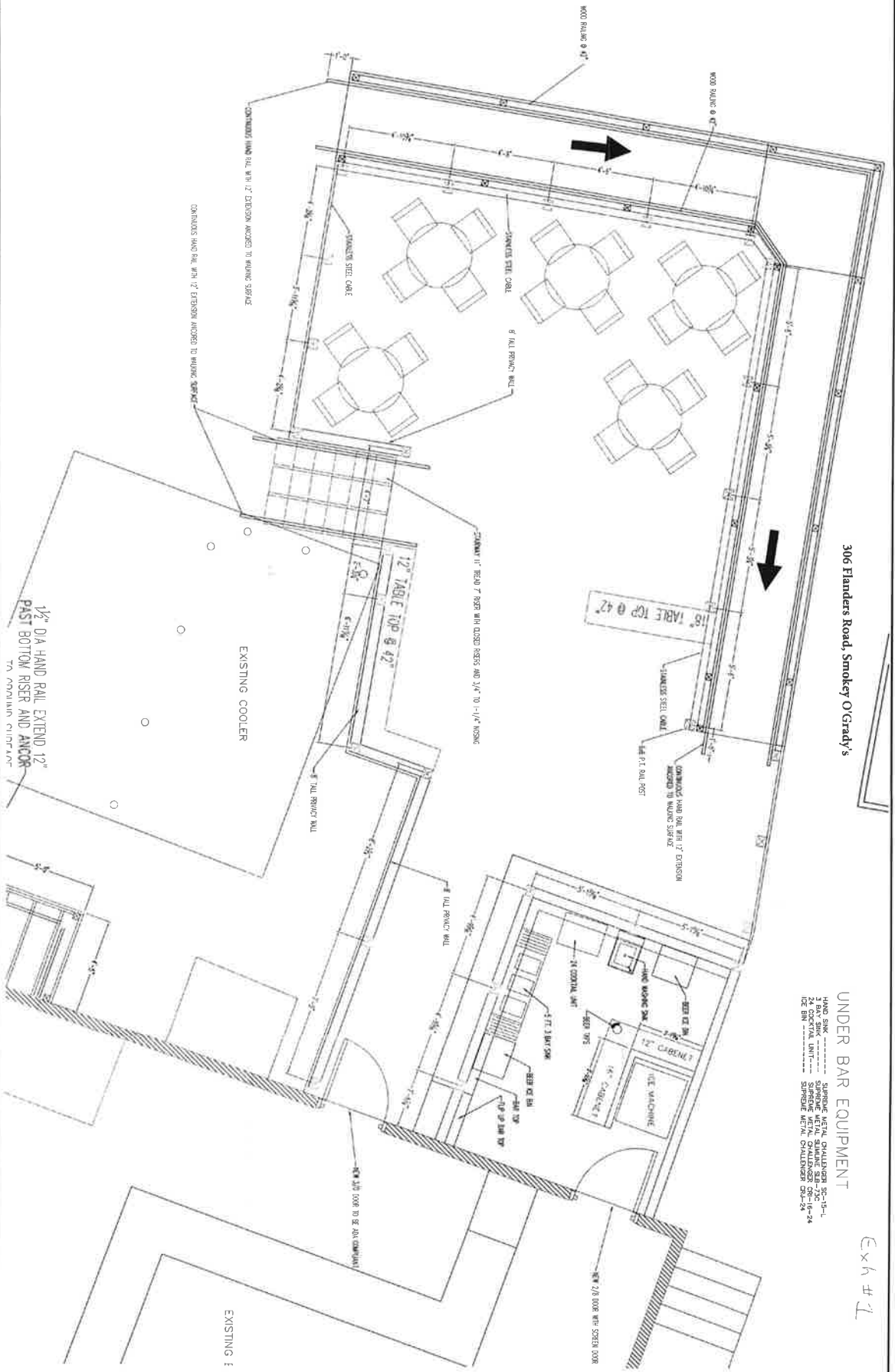

<p>THIS DRAWING HAS BEEN MADE IN ACCORDANCE WITH THE RULES AND REGULATIONS OF THE BOARD OF SURVEYORS AND LAND SURVEYORS OF THE STATE OF CONNECTICUT. THE SURVEYOR'S PROFESSIONAL SEAL AND SIGNATURE ARE REQUIRED FOR THIS DRAWING TO BE VALID.</p>	<p>DATE: March 22, 2009</p>	<p>DRAWN BY: ROP</p>
<p>J. ROBERT PFANNER & ASSOCIATES, P.C. CIVIL ENGINEERS & LAND SURVEYORS 17 GRAND STREET, NAANTIC, CONNECTICUT 06357 TEL: 860-739-6216 FAX: 860-739-0833</p>	<p>DESCRIPTION</p>	<p>SCALE: 1/2" = 1'-0"</p>
<p>LOCATION: 306 Flanders Road, Smokey O'Grady's</p>	<p>SHEET TITLE: Deck Layout</p>	<p>SHEET NUMBER: 4 of 5</p>