

# Town of East Lyme

## APPLICATION FOR SPECIAL PERMIT

Date of Application: 2/15/22 Zone: \_\_\_\_\_

Applicant's Name: Chris Herbert, dba La Llarona

Applicant's Address: 267-283 Main Street, Niantic (aka 13 Hope St) Telephone: (860) 739-5033

Location of Affected Premises: 267-283 Main Street Assessor's Map/Block/Lot: 12.1/103

Owner of Record: Mitchell Trust, LLC 48 Attawan Road, Niantic Volume/Page: 443/335

**DESCRIPTION OF SPECIAL PERMIT REQUESTED** {Requires compliance with Zoning Regulations 24, 25 & 9 and all other applicable Zoning Regulations of the Town of East Lyme; also state which sections of Zoning Regulations Special Permit is subject to}:

Renewal of Special Permit Application for Outdoor Dining at the above referenced premises with the following previously approved conditions: No outdoor entertainment after 11:00 p.m.

Signature of Owner: 

Signature of Applicant: 

**Attach a true copy of the Deed and a Site Plan {10 copies required}**. A copy of the deeds for all affected properties and a site plan demonstrating compliance with all applicable zoning code requirements must accompany this application.

**Proof of posting of Special Permit Application public notice sign (Section 25.4.3-1)**. Proof of posting of the Special Permit Application for Public Notice must be submitted.

\*\*\*\*\*

### Below this line for Office Use Only:

\*\*\*\*\*

Deed Copies Attached:	YES	NO	PERMIT FEE:	SPECIAL PERMIT FEE	\$150.00	\$150.00
				OUTDOOR DINING RENEWAL	\$20.00	—
Site Plan Attached:	YES	NO	N/A	SITE PLAN FEE	\$200.00	—
				STORM WATER	\$200.00	—
				STATE FEE:		\$60.00
CHECK #:	<u>1208</u>			TOTAL DUE:		<b>\$ \$210.00</b>

Date Approved: \_\_\_\_\_ Date Denied: \_\_\_\_\_

Approval subject to conditions below:

- \_\_\_\_\_
- \_\_\_\_\_

Approval to become effective upon publication and date of entry into the land records of the Town of East Lyme affecting the premises as described in this application.

Date: \_\_\_\_\_ Attest \_\_\_\_\_

East Lyme Zoning Chairman

267-283 Main St Existing

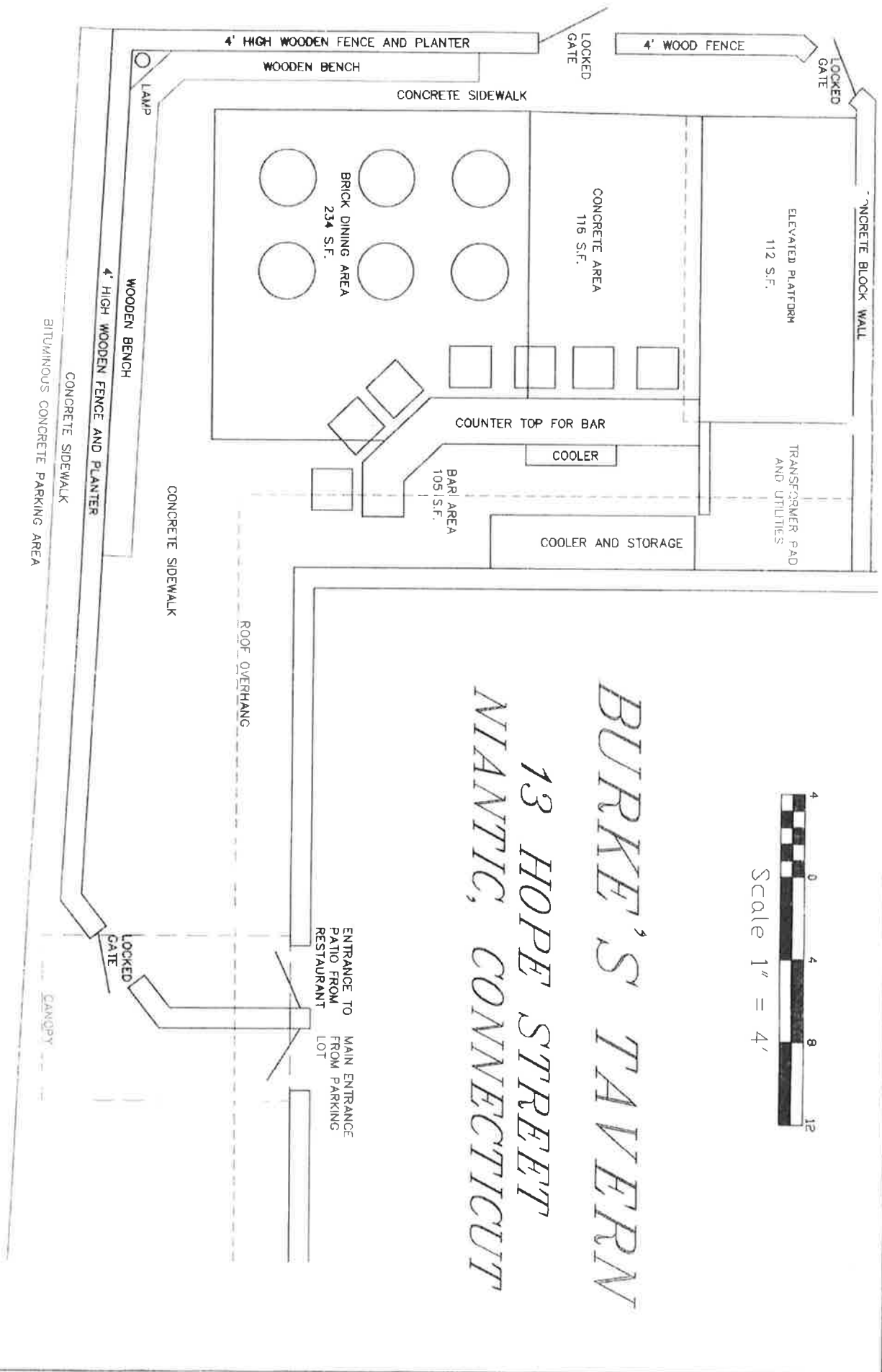

BURKE'S TAVERN  
13 HOPE STREET  
NANTIC, CONNECTICUT

