

Town of East Lyme

APPLICATION FOR SPECIAL PERMIT

Date of Application: 2/8/2022 Zone: _____

Applicant's Name: Five Churches By The Bay

Applicant's Address: P.O. Box 308, New Britain, CT 06050 Telephone: 860-250-3343

Location of Affected Premises: 215 Main st Niantic, CT Assessor's Map/Block/Lot: 12.1/72

Owner of Record: Niantic Morton House LLC Volume/Page: 549/257

Owner's Address: 7 Upper Heather Wood 5 Iron Gate Lane, Cromwell Ct 06416 Telephone: 860-394-1309

DESCRIPTION OF SPECIAL PERMIT REQUESTED {Requires compliance with Zoning Regulations 24, 25 & 9 and all other applicable Zoning Regulations of the Town of East Lyme; also state which sections of Zoning Regulations Special Permit is subject to}:

permit for use of patio for outside dining area

Signature of Owner: Donald Mondini - member Niantic Morton House LLC

Signature of Applicant: [Signature] member

Attach a true copy of the Deed and a Site Plan {10 copies required}. A copy of the deeds for all affected properties and a site plan demonstrating compliance with all applicable zoning code requirements must accompany this application.

Proof of posting of Special Permit Application public notice sign (Section 25.4.3-1). Proof of posting of the Special Permit Application for Public Notice must be submitted.

Below this line for Office Use Only:

Deed Copies Attached: YES NO	PERMIT FEE: SPECIAL PERMIT FEE	\$150.00	
	OUTDOOR DINING RENEWAL	\$20.00	<u>20.00</u>
Site Plan Attached: YES NO N/A	SITE PLAN FEE	\$100.00	
	STORM WATER	\$300.00	
	STATE FEE:	\$60.00	
CHECK #: <u>1002</u>	TOTAL DUE:		\$ <u>80.00</u>

Date Approved: _____ Date Denied: _____

Approval subject to conditions below:

1. _____
2. _____

Approval to become effective upon publication and date of entry into the land records of the Town of East Lyme affecting the premises as described in this application.

Date: _____

East Lyme Zoning Commission

Five Churches By The Bay

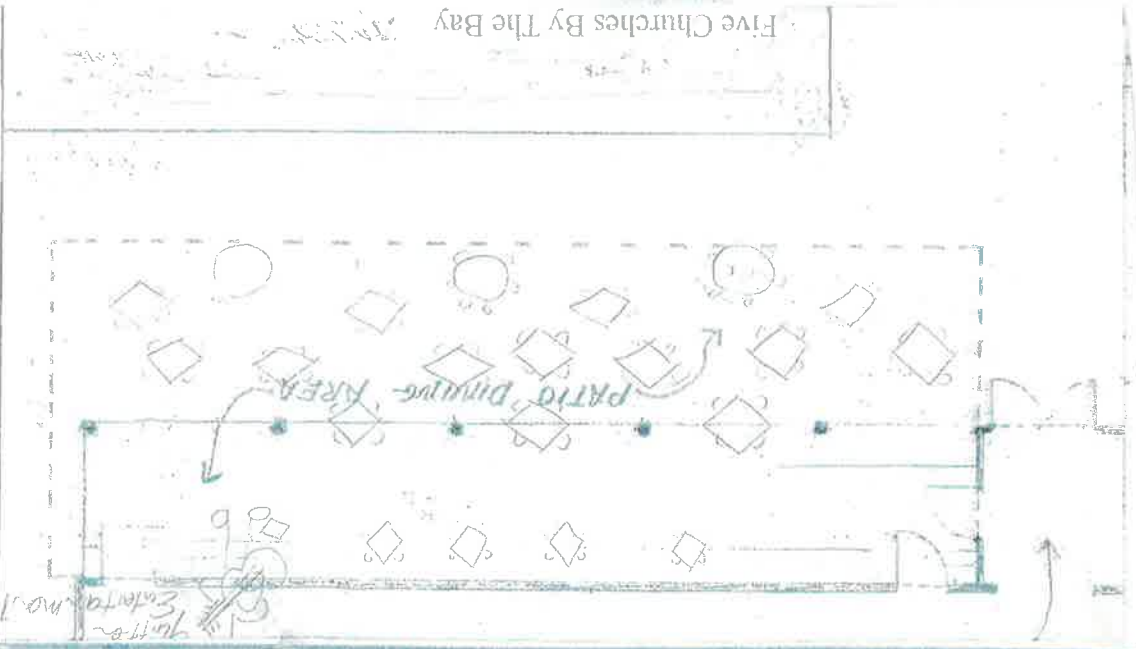

Entrance

Exit

This is what we intend to do at the property located at 215 Main st, Niantic.

We want to open a restaurant, the name is Five Churches By the Bay.

We want to have a " open air " bar that will be located in the corridor> The 3 windows in the center of the building we would like to replace with a 2 pannel full view garage doors, so if you are sitting inside you will have full view of the water, and if you are sitting outside at the bar.

The patio will be an outside dining area.

The old " banquet" room will be the main dining area, these areas will be serviced by a wait staff
the number of staff will be determined by the capacity of seating.

The kitchen will remain the kitchen.

We want to start with a simple menu, we are going to have wood fired pizza, burgers, wings, soft pretzles, nachos and a vegetarian and gluten friendly options.

We do not want to limit our menu to these items, we fully intend to expand as we move along.

But for starters we would like to keep it simple.