



# APPLICATION FOR PERMIT EAST LYME INLAND WETLANDS AGENCY

CR # 5603		Office Use Only
Fee Paid <u>160.00</u>	Date Submitted <u>9/22/21</u>	Application # _____
Date of Receipt _____	Date Approved _____	Permit Number _____
Major Impact: YES NO    Public Hearing: YES NO    Agent Approved: YES NO		

Note: In accordance with the Inland Wetland and Watercourses Regulations, Eleven (11) copies of all application materials must be submitted.

1. SITE LOCATION (Street) and Description: Riverview Rd, Niantic  
 Assessor's Map 20 Lot # 6,7

Note: It is the applicant's responsibility to provide the correct site address, map/lot number for the legal notice. Provide a description of the land in sufficient detail to allow identification of the inland wetlands and watercourses, the area(s) (in acres or square feet) of wetlands and watercourses to be disturbed, soil type(s), and wetland vegetation.

2. APPLICANT: Andrew P. Clark, Forest Fractioner # SFPH000316  
 Address: 2 Sands Drive Phone: 860-227-0987  
Old Lyme, CT 06371 Fax: \_\_\_\_\_  
 Business: Limbitless Logging, LLC Cell: Same  
2 Sands Drive, Old Lyme CT 06371 Email: limbitlesslogging@comcast.net  
 Applicant's interest in the land: Logging Contractor

\*\*If the applicant is a Limited Liability Corporation or a Corporation provide the managing member's or responsible corporate officer's name, address, and telephone number.

3. OWNER: PJ Associates & John Pollok  
 Address: 49 Hunter Place Phone: 646-206-0592  
Stuy Point, NY 10980 Fax: \_\_\_\_\_  
 Email: JohnP@nexelus.net Cell: Same

\*\*As the legal owner of the property listed on this application, I hereby consent to the proposed activities. And I hereby authorize the members and agents of the Agency to inspect the subject land, at reasonable times, during the pendency of the application and for the life of the permit.

✓ Owners Printed Name: John Pollok  
 ✓ Owners Signature: [Signature] Date: 9/15/21

4. Area of wetland to be disturbed: 360 sq. ft. or ac \_\_\_\_\_  
Area of watercourse to be disturbed: \_\_\_\_\_ sq. ft. or ac \_\_\_\_\_  
Upland review area to be disturbed: 360 sq. ft. or ac \_\_\_\_\_

Will fill be needed on site? Yes  No   
If yes, how much fill is needed? N/A Cubic yards

5. The property contains (circle one or more)

WATERCOURSE WATERBODY WOODED-WETLAND SWAMP  
FLOODPLAIN OTHER: \_\_\_\_\_

Description of soil types on site: 75E, 73C, 38C, 61C - Very Rocky site  
With exposed glacial fill and ledge.

Description of wetland vegetation: Skunk Cabbage

Name of Soil Scientist(s) and date of survey: \_\_\_\_\_

6. Provide a written narrative of the purpose and a description of the proposed activity and proposed erosion and sedimentation controls and other best management practices and mitigation measures which may be considered as a condition of issuing a permit for the proposed regulated activity including, but not limited to, measures to (1) prevent or minimize pollution or other environmental damage, (2) maintain or enhance existing environmental quality, or (3) in the following order of priority: restore, enhance and create productive wetland or watercourse resources. Depending on the complexity of the project, include the following: construction schedule, sequence of operations, drainage computations with pre and post construction runoff quantities and runoff rates, plans clearly showing the drainage areas corresponding to the drainage computation, existing wetland inventory and functional assessment, soils report, construction plans signed by a certified soils scientist, licensed surveyor, and licensed professional engineer.

7. Provide information of all alternatives considered. List all alternatives which would cause less or no environmental impact to wetlands or watercourses and state why the alternative as set forth in the application was chosen. All such alternatives shall be diagramed on a site plan or drawing. (Attach plans showing all alternates considered).

See Attached

8. Attach a site plan showing the proposed activity and existing and proposed conditions in relation to wetlands and watercourses and identifying any further activities associated with, or reasonably related to, the proposed regulated activity which are made inevitable by the proposed regulated activity and which may have an impact on wetlands and watercourses.

9. Provide the name and mailing addresses of adjacent landowners (including across a street). Attach additional sheets if necessary.

Name/Address: See Attached

Name/Address: \_\_\_\_\_

Name/Address: \_\_\_\_\_

4. Area of wetland to be disturbed: 3400 sq. ft. or ac \_\_\_\_\_  
Area of watercourse to be disturbed: \_\_\_\_\_ sq. ft. or ac \_\_\_\_\_  
Upland review area to be disturbed: 260 sq. ft. or ac \_\_\_\_\_

Will fill be needed on site? Yes  No   
If yes, how much fill is needed? N/A Cubic yards

5. The property contains (circle one or more)

WATERCOURSE

WATERBODY WOODED-WETLAND

SWAMP

FLOODPLAIN

OTHER: \_\_\_\_\_

Description of soil types on site: T5E, T3C, 38C, 61C - Very Rocky site with exposed glacial fill and ledge.

Description of wetland vegetation: Skunk Cabbage

Name of Soil Scientist(s) and date of survey: \_\_\_\_\_

6. Provide a written narrative of the purpose and a description of the proposed activity and proposed erosion and sedimentation controls and other best management practices and mitigation measures which may be considered as a condition of issuing a permit for the proposed regulated activity including, but not limited to, measures to (1) prevent or minimize pollution or other environmental damage, (2) maintain or enhance existing environmental quality, or (3) in the following order of priority: restore, enhance and create productive wetland or watercourse resources. Depending on the complexity of the project, include the following: construction schedule, sequence of operations, drainage computations with pre and post construction runoff quantities and runoff rates, plans clearly showing the drainage areas corresponding to the drainage computation, existing wetland inventory and functional assessment, soils report, construction plans signed by a certified soils scientist, licensed surveyor, and licensed professional engineer.

7. Provide information of all alternatives considered. List all alternatives which would cause less or no environmental impact to wetlands or watercourses and state why the alternative as set forth in the application was chosen. All such alternatives shall be diagramed on a site plan or drawing. (Attach plans showing all alternates considered).

See Attached.

8. Attach a site plan showing the proposed activity and existing and proposed conditions in relation to wetlands and watercourses and identifying any further activities associated with, or reasonably related to, the proposed regulated activity which are made inevitable by the proposed regulated activity and which may have an impact on wetlands and watercourses.

9. Provide the name and mailing addresses of adjacent landowners (including across a street). Attach additional sheets if necessary.

Name/Address: See Attached

Name/Address: \_\_\_\_\_

Name/Address: \_\_\_\_\_



10. Attach a completed DEP reporting form.

*The Agency shall revise or correct the information provided by the applicant and submit the form to the Commissioner of Environmental Protection in accordance with section 22a-30-14 of the Regulations of Connecticut State Agencies.*

11. Name of Erosion Control Agent (Person Responsible for Compliance):

\_\_\_\_\_ Same as Applicant \_\_\_\_\_

Address: \_\_\_\_\_

Phone: \_\_\_\_\_

\_\_\_\_\_

Fax: \_\_\_\_\_

Email: \_\_\_\_\_

Cell: \_\_\_\_\_

12. Are you aware of any wetland violations (past or present) on this property? Yes  No

If yes, please explain: \_\_\_\_\_

13. Are there any vernal pools located on or adjacent (within 500') to the property? Yes  No

14. For projects that do not fall under the ACOE Category I general permit – Have you contacted the Army Corps of Engineers? Yes  No

15. Is this project within a public water supply aquifer protection area or a watershed area? Yes  No

16. If so, have you notified the Commissioner of the Connecticut Department of Public Health and the East Lyme Water and Sewer Department? Yes  No  (Proof of notification must be submitted with your application).

17. Attach the appropriate filing fee based on the fee schedule established in Section 19 of the Regulations.  
Fee: \$160<sup>00</sup> (Make checks payable to "Town of East Lyme").

18. PUBLIC HEARINGS ONLY: The applicant must provide proof of mailing notices to the abutters prior to the hearing date.

*The undersigned Applicant hereby consents to necessary and proper inspection of the above mentioned property by the East Lyme Inland Wetlands Agency and/or its agents at reasonable times both before and after the permit in question has been granted.*

*The Applicant affirms that the information supplied in this application is accurate to the best of his/her knowledge and belief. As the applicant I hereby certify that I am familiar with the information provided in this application and I am aware of the penalties for obtaining a permit through deception or through inaccurate or misleading information.*

Printed Name: Andrew P. Clark Date: 9/20/21

Signature: 

Please note:

*Above notice to be published in legal section of newspaper having general circulation in the Town of East Lyme. Applicant to pay cost of publication. You or a representative must attend the Inland Wetlands Agency meeting to present your application.*





## SCCOG Abutters Report

200ft. Abutters of Property 45-20.0.6  
at RIVERVIEW RD

Please be aware that the abutters list reflects mailing address for the real estate tax bills as requested by the property owners. Mortgage companies, banks and other financial institutions may be receiving the notification and not the homeowner as required. Please be sure you are complying with notification requirements. Property data updated 05/04/2021.

Abutters	Street Address	Account Number	Owner Address
10.0.2	199 W MAIN ST		CONNECTICUT STATE OFFNCI & JB GATES PRISON 199 W MAIN ST , CT 06357
15.0.2	91 ROXBURY RD		EAST LYME TOWN OFTRANSFER STATION PO BOX 519 , CT 06357-0519
20.0.7	52-54 SOCIETY RD		POLLOCK JOHN H 54 SOCIETY RD , CT 06357
21.0.4	46 RIVERVIEW RD		CARLSON CANDACE DEE & CARLSON CURTIS M 46 RIVERVIEW RD , CT 06357
21.0.5	50 RIVERVIEW RD		PURVIS BETTY W 50 RIVERVIEW RD , CT 06357
21.0.6	76 RIVERVIEW RD		GADA ROBERT GEORGE & BETTY 76 RIVERVIEW RD , CT 06357
21.0.7	78 RIVERVIEW RD		FENICK CHARLES L & JOAN M PO BOX 571 , CT 06357
21.0.7-1	80 RIVERVIEW RD		FENICK JOSHUA D 80 RIVERVIEW RD , CT 06357







## SCCOG Abutters Report

200ft. Abutters of Property 45-20.0 6  
at RIVERVIEW RD

Please be aware that the abutters list reflects mailing address for the real estate tax bills as requested by the property owners. Mortgage companies, banks and other financial institutions may be receiving the notification and not the homeowner as required. Please be sure you are complying with notification requirements. Property data updated 05/04/2021.

21.1 2	86 RIVERVIEW RD		SALVATORE JOSEPH R 86 RIVERVIEW RD , CT 06357
21.1 3	94 RIVERVIEW RD		POLLOK JOHN H & WARREN PETER 49 HUNTER PLACE , NY 10980
21.1 4	SOCIETY RD		NIANTIC COMM CHURCH INC 170 PENNSYLVANIA AVE , CT 06357
21.1 67	107 RIVERVIEW RD		DOAK EUGENE H & DONNA 107 RIVERVIEW RD , CT 06357
21.1 68	103 RIVERVIEW RD		POTHIER ORBRA C & LINDAL 103 RIVERVIEW RD , CT 06357
21.1 69	99 RIVERVIEW RD		WERNQUEST CHARLES A & WERNQUEST JOHANNE 99 RIVERVIEW RD , CT 06357
21.1 70	93 RIVERVIEW RD		SIRAGUSA JOSEPH & KRISTEN 15 STONE RANCH RD , CT 06333
21.1 71 MAIN	91 RIVERVIEW RD		,
21.1 71 MAIN	91 RIVERVIEW RD		,
21.1 71 MAIN	91 RIVERVIEW RD		,
21.1 71 MAIN	91 RIVERVIEW RD		,





## SCCOG Abutters Report

200ft. Abutters of Property 45-20.0 6  
at RIVERVIEW RD

Please be aware that the abutters list reflects mailing address for the real estate tax bills as requested by the property owners. Mortgage companies, banks and other financial institutions may be receiving the notification and not the homeowner as required. Please be sure you are complying with notification requirements. Property data updated 05/04/2021.

21.3 8	58 RIVERVIEW RD		MIKO ALEXANDRA M 58 RIVERVIEW RD , CT 06357
21.3 9	62 RIVERVIEW RD		SILVIA FRANK J & KATHERINE 62 RIVERVIEW RD , CT 06357
25.0 36	72 SOCIETY RD		TYDEMAN THOMAS ALBERT & TYDEMAN REBECCA MARIE 72 SOCIETY RD , CT 06357
25.0 41	92 SOCIETY RD		BUDNEY LISA TR & KEVIN TR 74 QUINCY TR , CT 06037
25.0 41-1	94 SOCIETY RD		VALENTIN NADA & VALENTIN ANTHONY J 94 SOCIETY RD , CT 06357
25.0 42	SOCIETY RD		CONNECTICUT STATE OF STATE OFFICE BLDG , CT 06106



Character References for Andrew Clark, Limb-It-Less Logging, LLC

Douglas Emmerthal  
CT DEEP Division of Forestry  
860-424-3837

Joan Nichols  
Forester, Executive Director CT Farm Bureau  
860-768-1100 ext 106

Town of Sprague  
Conservation Commission  
Dave Gustafson  
860-705-1560

Town of Waterford CT  
Maureen Fitzgerald  
Wetlands Enforcement Official  
860-444-5813





# Statewide Inland Wetlands & Watercourses Activity Reporting Form

Please complete and mail this form in accordance with the instructions on pages 2 and 3 to:  
DEEP Land & Water Resources Division, Inland Wetlands Management Program, 79 Elm Street, 3<sup>rd</sup> Floor, Hartford, CT 06106  
Incomplete or incomprehensible forms will be mailed back to the inland wetlands agency.

## PART I: Must Be Completed By The Inland Wetlands Agency

- DATE ACTION WAS TAKEN: year: \_\_\_\_\_ month: \_\_\_\_\_
- ACTION TAKEN (see instructions, only use one code): \_\_\_\_\_
- WAS A PUBLIC HEARING HELD (check one)? yes  no
- NAME OF AGENCY OFFICIAL VERIFYING AND COMPLETING THIS FORM:  
(print name) \_\_\_\_\_ (signature) \_\_\_\_\_

## PART II: To Be Completed By The Inland Wetlands Agency Or The Applicant

- TOWN IN WHICH THE ACTION IS OCCURRING (print name): East Lyme  
does this project cross municipal boundaries (check one)? yes  no   
if yes, list the other town(s) in which the action is occurring (print name(s)): \_\_\_\_\_
- LOCATION (see instructions for information): USGS quad name: Niantic or number: 101  
subregional drainage basin number: 2205
- NAME OF APPLICANT, VIOLATOR OR PETITIONER (print name): Andrew Clark #SFPH000316
- NAME & ADDRESS / LOCATION OF PROJECT SITE (print information): Riverview Rd, Niantic, CT  
briefly describe the action/project/activity (check and print information): temporary  permanent  description: Temporary Stream Crossing For a Timber Harvest Operation
- ACTIVITY PURPOSE CODE (see instructions, only use one code): BG
- ACTIVITY TYPE CODE(S) (see instructions for codes): 12
- WETLAND / WATERCOURSE AREA ALTERED (must provide acres or linear feet):  
wetlands: \_\_\_\_\_ acres open water body: \_\_\_\_\_ acres stream: \_\_\_\_\_ linear feet
- UPLAND AREA ALTERED (must provide acres): \_\_\_\_\_ acres
- AREA OF WETLANDS / WATERCOURSES RESTORED, ENHANCED OR CREATED (must provide acres): 0 acres

DATE RECEIVED:

## PART III: To Be Completed By The DEEP

DATE RETURNED TO DEEP:

FORM COMPLETED: YES NO

FORM CORRECTED / COMPLETED: YES NO

9. Carefully review the list below and enter ONLY ONE code letter which best characterizes the action/project/activity. All state agency projects must code "N".

A = Residential Improvement by Homeowner  
 B = New Residential Development for Single Family Units  
 C = New Residential Development for Multi-Family / Condos  
 D = Commercial / Industrial Uses  
 E = Municipal Project  
 F = Utility Company Project  
 G = Agriculture, Forestry or Conservation  
 H = Wetland Restoration, Enhancement, Creation

I = Storm Water / Flood Control  
 J = Erosion / Sedimentation Control  
 K = Recreation / Boating / Navigation  
 L = Routine Maintenance  
 M = Map Amendment  
 N = State Agency Project  
 P = Other (this code includes the approval of concept plans with no-on-the-ground work)

10. Enter between one and four code numbers to best characterize the project or activity being reported. Enter "NA" if this form is being completed for the action of map amendment. You MUST provide code 12 if the activity is located in an established upland review area. You MUST provide code 14 if the activity is located beyond the established upland review area or no established upland review area exists.

1 = Filling  
 2 = Excavation  
 3 = Land Clearing / Grubbing (no other activity)  
 4 = Stream Channelization  
 5 = Stream Stabilization (includes lakeshore stabilization)  
 6 = Stream Clearance (removal of debris only)  
 7 = Culverting (not for roadways)

8 = Underground Utilities Only (no other activities)  
 9 = Roadway / Driveway Construction  
 10 = Drainage Improvements  
 11 = Pond, Lake Dredging / Dam Construction  
 12 = Activity in an Established Upland Review Area  
 14 = Activity in Upland

**Examples:** Jurisdictional ruling allowing construction of a parking lot in an upland where the municipality does not have an established upland review area must use code 14, other possible codes are 2 and 10. Permitted construction of a free standing garage (residential improvement by homeowner) partially in an established upland review area with the remainder in the upland must use code 12 and 14, other possible codes are 1 and 2.

11. Leave blank for TEMPORARY alterations but please indicate action/project/activity is temporary under question #8 on the form. For PERMANENT alterations, enter in acres the area of wetland soils or watercourses altered. Include areas that are permanently altered, or are proposed to be, for all agency permits, denials, amendments, renewals, jurisdictional rulings, and enforcement actions. For those activities that involve filling or dredging of lakes, ponds or similar open water bodies enter the acres filled or dredged under "open water body". For those activities that involve directly altering a linear reach of a brook, river, lakeshore or similar linear watercourse, enter the total linear feet altered under "stream". Remember that these figures represent only the acreage altered not the total acreage of wetlands or watercourses on the site. You MUST provide all information in ACRES (or linear feet as indicated) including those areas less than one acre. To convert from square feet to acres, divide square feet by the number 43,560. If this report is being completed for an agency jurisdictional ruling and detailed information is not available, provide an estimate. Enter zero if there is no alteration.
12. Enter in acres the area of upland altered as a result of an ACTIVITY REGULATED BY the inland wetlands agency, or as a result of an AGENT APPROVAL pursuant to CGS section 22a-42a(c)(2). Leave blank for TEMPORARY alterations but please indicate action/project/activity is temporary under question #8 on the form. Include areas that are permanently altered, or proposed to be permanently altered, for all agent approvals, agency permits, denials, amendments, renewals, jurisdictional rulings, and enforcement actions. You MUST provide all information in ACRES including those areas less than one acre. See directions above (#11) for conversion factor. If this report is being completed for an agent approval or an agency jurisdictional ruling and detailed information is not available, provide an estimate. Enter zero if there is no alteration.
13. Enter the acres that are, or are proposed to be, restored, enhanced or created for all agency permits, denials, amendments, renewals, jurisdictional rulings and enforcement actions. NOTE restored or enhanced applies to previously existing wetlands or watercourses. Created applies to a non-wetland or non-watercourse area which is converted into wetlands or watercourses (question #10 must provide 12 and/or 14 as an answer, and question #12 must also be answered). You MUST provide all information in ACRES including those areas less than one acre. See directions above (#11) for conversion factor. Enter zero if there is no restoration, enhancement or creation.

**PART III: To Be Completed By The DEEP** - Please leave this area blank. Incomplete or incomprehensible forms will be mailed back to the inland wetlands agency.



# INSTRUCTIONS FOR COMPLETING THE STATEWIDE INLAND WETLANDS & WATERCOURSES ACTIVITY REPORTING FORM

Use a separate form to report EACH action taken by the Agency. Complete the form as described below.  
Do NOT submit a reporting form for withdrawn actions.

## PART I: Must Be Completed By The Inland Wetlands Agency

1. Choose the year and month the Inland Wetlands Agency took the action being reported. If multiple actions were taken regarding the same project or activity then multiple forms need to be completed.
2. Choose ONE code letter to describe the final action or decision taken by the Inland Wetlands Agency. Do NOT submit a reporting form for withdrawn actions. Do NOT enter multiple code letters (for example: if an enforcement notice was given and subsequent permit issued - two forms for the two separate actions are to be completed).
  - A = A Permit Granted by the Inland Wetlands Agency (not including map amendments, see code D below)
  - B = Any Permit Denied by the Inland Wetlands Agency
  - C = A Permit Renewed or Amended by the Inland Wetlands Agency
  - D = A Map Amendment to the Official Town Wetlands Map - or -  
An Approved/Permitted Wetland or Watercourse Boundary Amendment to a Project Site Map
  - E = An Enforcement Action: Permit Revocation, Citation, Notice of Violation, Order, Court Injunction, or Court Fines
  - F = A Jurisdictional Ruling by the Inland Wetlands Agency (i.e.: activities "permitted as of right" or activities considered non-regulated)
  - G = An Agent Approval pursuant to CGS 22a-42a(c)(2)
  - H = An Appeal of Agent Approval Pursuant to 22a-42a(c)(2)
3. Check "yes" if a public hearing was held in regards to the action taken; otherwise check "no".
4. Enter the name of the Inland Wetlands Agency official verifying that the information provided on this form is accurate and that it reflects the FINAL action of the agency.

## PART II: To Be Completed By The Inland Wetlands Agency Or The Applicant - If Part II is completed by the applicant, the applicant MUST return the form to the Inland Wetlands Agency. The Inland Wetlands Agency MUST ensure that the information provided is accurate and that it reflects the FINAL action of the Agency.

5. Enter the name of the municipality for which the Inland Wetlands Agency has jurisdiction and in which the action/project/activity is occurring.

Check "yes" if the action/project/activity crosses municipal boundaries and enter the name(s) of the other municipality(ies) where indicated. Check "no" if it does not cross municipal boundaries.
6. Enter the USGS Quad Map name or number (1 through 115) as found on the Connecticut Town and Quadrangle Index Map (the directory to all USGS Quad Maps) that contains the location of the action/project/activity. Click on the following website for USGS Quad Map information:  
[http://ct.gov/deep/lib/deep/gis/resources/Index\\_NamedQuadTown.pdf](http://ct.gov/deep/lib/deep/gis/resources/Index_NamedQuadTown.pdf)

ALSO enter the four-digit identification number of the corresponding Subregional Drainage Basin in which the action/project/activity is located. If the action/project/activity is located in more than one subregional drainage basin, enter the number of the basin in which the majority of the action/project/activity is located. Town subregional drainage basin maps can be found at UConn - CLEAR's website: [http://clear.uconn.edu/data/map\\_set/index.htm](http://clear.uconn.edu/data/map_set/index.htm)
7. Enter the name of the individual applying for, petitioning, or receiving the action.
8. Enter the name and address or location of the action/project/activity. Check if the action/project/activity is TEMPORARY or PERMANENT in nature. Also provide a brief DESCRIPTION of the action/project/activity. It is always best to provide as much information as possible (i.e., don't just state "forestry", provide details such as "20 acre forestry harvest, permit required for stream crossing".)



## **STATEWIDE INLAND WETLANDS & WATERCOURSES ACTIVITY REPORTING FORM**

**Pursuant** to section 22a-39(m) of the General Statutes of Connecticut and section 22a-39-14 of the **Regulations** of Connecticut State Agencies, inland wetlands agencies must complete the Statewide **Inland Wetlands & Watercourses Activity Reporting Form** for **each** action taken by such agency.

**This form** may be made part of a municipality's inland wetlands application package. If the municipality **chooses** to do this, it is recommended that a copy of the Town and Quadrangle Index of Connecticut **and a** copy of the municipality's subregional drainage basin map be included in the package.

**Please** remember, the inland wetlands agency is responsible for ensuring that the information provided **is accurate** and that it reflects the **final** action of the agency. Incomplete or incomprehensible forms will **be mailed** back to the agency. Instructions for completing the form are located on the following pages.

The inland wetlands agency shall mail completed forms for actions taken during a calendar month no **later than** the 15<sup>th</sup> day of the following month to the Department of Energy and Environmental Protection (DEEP). Do **not** mail this cover page or the instruction pages. Please mail **only** the **completed** reporting form to:

DEEP Land & Water Resources Division  
Inland Wetlands Management Program  
79 Elm Street, 3<sup>rd</sup> Floor  
Hartford, CT 06106

Questions may be directed to the DEEP's Inland Wetlands Management Program at (860) 424-3019.

**Appendix D - ORDINANCE ESTABLISHING SCHEDULE OF FEES FOR CONSERVATION, PLANNING AND ZONING COMMISSIONS**

1.1	Application Fee **	
1.1.1	Residential Uses.....	\$150.00 Plus *\$50.00/LOT
	Plus Fee from Schedule A	
1.1.2	Commercial Uses.....	\$400.00
	Plus Fee from Schedule A	
1.1.3	All Other Uses . .....	\$200.00
	Plus Fee from Schedule A	
	*Each lot with regulated activities	
	**\$60 fee required by C.G.S 22a-27j will be added to the base fees.	
1.2	Approval by Duly Authorized Agent **	\$100.00
1.3	Appeal of Duly Authorized Agent Decision.....	\$300.00
1.4	Significant Activity Fee	\$300.00
1.5	Public Hearing Fee	
1.5.1	Single Residential	\$200.00
1.5.2	Commercial/Industrial/Multi-Family	\$450.00
1.6	Complex Application Fee .....	Actual Cost
	The Inland Wetlands Agency may charge an additional fee sufficient to cover the cost of reviewing and acting on complex applications. Such fee may include, but not be limited to, the cost of retaining experts, to advise, analyze, review, and report on issues requiring such experts. The Agency or the duly authorized agent shall estimate the complex application fee, which shall be paid pursuant to section 19.1 of these regulations within 10 days of the applicant's receipt or notice of such estimate. Any portion of the complex application fee in excess of the actual cost shall be refunded to the applicant no later than 30 days after publication of the agency's decision.	
1.7	Permitted and Nonregulated Uses :	
1.7.1	Permitted Uses as of Right .....	\$0.00
1.7.2	Nonregulated ... ..	\$0.00
1.8	Regulation Amendment Petitions .....	\$500.00
	(Does not include Notices or Regulation Advisories from DEP)	
1.8.1	Map Amendment Petitions .....	\$500.00
	Plus Fee from Schedule B	
1.9	Modification of Previous Approval: .....	\$100.00
1.10	Renewal of Previous Approval .. ..	\$100.00
1.11	Monitoring Compliance Fee .....	\$100.00
1.12	SCHEDULE A. For the purpose of calculating the permit application fee, the area in schedule A is the total area of wetlands and watercourses and the upland review area upon which a regulated activity is proposed.	
	SQUARE FEET of AREA	
1.12.1.	Less than 1,000. ....	\$0.00
1.12.2.	1,000 to 5,000 ... ..	\$250.00
1.12.3.	More than 5,000 .....	\$750.00
1.13	SCHEDULE B. For the purpose of calculating the map amendment petition fee, linear feet in schedule B is the total length of wetlands and watercourses boundary subject to the proposed boundary change.	
	LINEAR FEET	
1.13.1.	Less than 500 ....	\$0.00
1.13.2	500 to 1,000 .....	\$250.00
1.13.3	More than 1,000.....	\$750.00



## NOTIFICATION OF TIMBER HARVEST

Town: East Lyme Date: 8/20/21  
 Property Location: Riverview Rd, Niantic CT

List all parcels:

Assessor's Info:

Map	Block	Lot
20	0	6
20	0	7

OR:

Unique ID

Total acreage of property(s): 93 Acres

Total acreage of harvest area: 70 +/-

Landowner(s) of Record: PJ Associates & John Pollock  
 Mailing Address: 49 Hunter Place  
 Town: Stony Point NY Zip 10980  
 Phone (646) 206-6592 John Pollock  
 E-mail: JohnP@nexclus.net

Primary Contact: Andrew Clark  
 Mailing Address: 2 Sands Drive  
 Town: Old Lyme CT 06371 Zip 06371  
 Phone (860) 227-0987  
 E-mail: limbitlesslogging@comcast.net

**Note:** Timber harvesting is a *Permitted as of Right Activity* pursuant to the Inland Wetlands and Watercourses Act, except for those practices regulated under Section 22a-36 through 22a-45 of the Connecticut General Statutes.

Is there a current forest management/stewardship plan for this property? Yes  No

This timber harvest has been prepared by a State of Connecticut certified:

(Check one): Forester  OR  Supervising Forest Products Harvester

Forest Practitioner Certificate #: SFPH000316

Name: Andrew Clark

Address: 2 Sands Drive Old Lyme CT 06371

E-mail: limbitlesslogging@comcast.net

Phone #: (Business) \_\_\_\_\_ (Cell) 860-227-0987

**Property Boundaries:**

Bounds are marked:  Yes  No

**Timber Harvest Boundaries:**

Have been marked or flagged:  Yes  No

Have owners of all lands within 100 feet of the harvest area been notified via first-class mail prior to filing this "Notification of Timber Harvest"? Yes  No

Estimated starting date of timber harvesting operations: 10/01/21

**Description of Timber Harvest:**

Objective: \* See Attached \*

Treatment: \_\_\_\_\_

**Amount of forest products to be harvested:**

260,000 Board feet \_\_\_\_\_ Cords \_\_\_\_\_ Cubic feet \_\_\_\_\_ Tons

**How have the trees to be harvested been designated?**

They have been marked with paint at eye level and at ground level. Paint color(s): Blue

They have not been marked

This is not an official CT DEP form but it has been endorsed for town usage by: CT Farm Bureau Assoc., CT Forest & Park Assoc., CT Professional Timber Producers, Society of American Foresters - CT Chapter, and others.

**SOIL, WATER AND INLAND WETLANDS RESOURCES**

**Actions Being Performed On This Land**

(Check all that apply and locate on attached Timber Harvest Area map -- see information below on maps.)

<p align="center"><u>Crossings / Clearing</u></p> <input checked="" type="checkbox"/> Temporary stream/drainage crossing <input type="checkbox"/> Temporary wetlands crossing <input type="checkbox"/> Removal of trees in wetlands <input type="checkbox"/> Removal of trees in upland review area	<p align="center"><u>Erosion and Sedimentation Control Measures:</u></p> <input checked="" type="checkbox"/> Installation of water bars <input checked="" type="checkbox"/> Grading <input checked="" type="checkbox"/> Seeding <input type="checkbox"/> Other (describe below)
<p align="center"><u>Log landing area:</u></p> <input checked="" type="checkbox"/> anti-tracking pad <input type="checkbox"/> curb cut	<p align="center"><u>Roads</u></p> <p>Are new roads, other than skid trails, to be constructed for transport of logs or other activities associated with this harvest?</p> <input type="checkbox"/> Yes <input checked="" type="checkbox"/> No

Describe in further detail as necessary:

*\* See Attached \**

The following maps are attached to this "Notification" (Check all that apply)

- Copy of USGS topographic map with property outlined
- Copy of Assessor's map with property outlined
- Timber Harvest Area map showing outline of harvest area, main skid road locations, log landing area, truck access roads, inland wetlands, watercourses and any crossings

*The undersigned hereby swear that the information contained in this application is true, accurate and complete to the best of my (our) knowledge and belief and that the timber harvest will be conducted in accordance with the specifications outlined in this "Notification of Timber Harvest."*

Signature of Landowner(s): John H. Pollok Date: 8/30/21

Print/Type Name: John H. Pollok

Signature of Landowner(s): \_\_\_\_\_ Date: \_\_\_\_\_

Print/Type Name: \_\_\_\_\_

Signature of Certified Forest Practitioner: Andrew P. Clark Date: 8/20/21

Print Name: Andrew P. Clark

Certificate #: SFFH000 316 Expiration Date: 03/01/22

**Complete and Submit to:**

- The Municipal Inland Wetlands Agency/ies in which the property is located, and
- A courtesy copy of this Notification Form should also be sent to The Department of Environmental Protection, Division of Forestry 79 Elm Street, Hartford, CT, Tel: (860) 424-3630

*This is not an official CT DEP form but it has been endorsed for town usage by: CT Farm Bureau Assoc., CT Forest & Park Assoc., CT Professional Timber Producers, Society of American Foresters - CT Chapter, and others.*



## **Description of Timber Harvest Activity**

Limb-It-Less Logging, LLC will be implementing a selection timber harvest on the property of PJ Associates and John Pollok located on Riverview Rd. in the Town of Niantic, Map 20 Lots 6 & 7 containing a combined 93 +/- acres and more particularly identified on the attached "Timber Harvest Map Property of PJ Associates & John Pollok", for the Fall/Winter of 2021/2022. The objective of the harvest is to thin the over stocked and over mature hardwood sawtimber stands, to release juvenile and suppressed hardwood sawtimber, and to increase the growth rate of the high quality hardwood sawtimber that will be left. This will create an uneven aged forest condition and will be very beneficial to wildlife habitat as well. Access to the site will utilize existing road frontage off Riverview Road located just south of the Niantic Community Church Cemetery where the temporary landing area will be constructed.

## **Harvesting equipment**

The equipment that will be used on the site will be a Feller Buncher and log skidder. The Feller Buncher mechanically cuts the trees and directionally fells them away from wetlands, watercourses, and the leave trees. The skidder will be used to bunch the trees in the woods and transport them to the landing where the trees will be merchandised into logs. This mix of machines and techniques will provide low impact to the forestland during and after the timber harvest.

## **Stream/Wetland Crossings**

Based on the GIS mapping available, this property contains approximately 10 acres of woodland wetlands. No more than 50% of the mature crown ratio and or 1/3 of the basal area will be removed within 100 feet of any wetlands or watercourses during this harvest operation. There is one perennial stream that runs through the property flowing in from the northern property line and following the eastern side of the property flowing south then turning east flowing toward Riverview Road until crossing under Riverview Road. One stream crossing identified as SC-1 on the Timber Harvest map will be needed to facilitate the harvest operations. A 25' solid top portable bridge will be used to facilitate the

---

crossing. The crossing is approximately 15 feet in width. The approaches are rocky and stable so no impact to the stream approaches are expected.

### **Sedimentation and Erosion Control plans**

Primary haul/skid roads will be constructed to minimize erosion possibilities and using the land's natural contours. Temporary haul/skid roads that will be constructed will run along contours when possible and not against them. Any sections of the haul/skid roads that have significant slopes will have water bars installed upon starting the harvest and will be maintained at all times during the harvest. Upon completion of the harvest, permanent water bars will be installed and any sections of the haul/skid roads that have significant slopes will be seeded and mulched to prevent erosion and sedimentation. The approach to SC-1 will be mulched and have hay bales staked on both approaches that will prevent sedimentation until the natural vegetation takes hold. If at any time during the harvest excessive rainfall occurs or the ground becomes soft, the harvest will be postponed until favorable conditions prevail and all preventive measures mentioned above will be implemented to reduce any risk of erosion and sedimentation.

### **Timber Harvest BMP's**

**Upland areas:** Stumps will be cut as low as possible. Trees will be directionally felled to minimize residual stand damage. Residual slash from the harvest will be lopped to 5'. Water bars will be installed on slopes. Haul/Skid Roads and landing areas will be seeded and mulched.

**Stream Crossing:** Upon completion of the harvest, the portable bridge will be removed and the approaches will be mulched and hay bales will be staked to prevent sedimentation.

**Buffer zones/Filter strips:** No more than one third (1/3) of the basal area and 50% of the mature crown ratio will be harvested in these areas with exception of areas that may have trees with exceptional storm damage, gypsy moth mortality, or EAB infestation. Skid trails will be located out of buffer zones/filter strips.

---



Trees will be felled away from wetlands/watercourses when possible to minimize disturbance. No slash will be left in wetland or watercourses to impede water flow. All BMP's and erosion control measures will strictly be followed in accordance to the CT DEEP's Best Management Practices Field Guide, 2012 edition.

Any questions, comments, or to schedule a site visit any time during the harvest operation, I can be reached at the contact info below. I invite anyone interested in learning how we design and implement a timber harvest, and utilize the forest products from the harvest, to contact me to schedule an appointment and would be happy to meet with you on the site.

Thank you,

A handwritten signature in black ink, appearing to read "Andrew Clark", is positioned above a faint rectangular stamp or watermark.

Andrew Clark  
Limb-It-Less Logging, LLC  
2 Sands Drive  
Old Lyme, CT 06371  
860-227-0987  
[limbitlesslogging@comcast.net](mailto:limbitlesslogging@comcast.net)

**FOREST PRACTITIONER CERTIFICATION DESCRIPTION**

Andrew Clark

Supervising Forest Products Harvester

Certification # S.F.P.H.000316

Expires 03/01/2022

**Supervising Forest Products Harvester:**

- May execute written or oral contracts or agreements for the purchase of commercial forest products from woodland owners.
- May supervise and participate in a commercial forest product harvesting operation.
- May mark trees as means of clearly designating which are to be cut and/or which are to be left uncut.
- May plan and design an operational or harvest plan.



**STATE OF CONNECTICUT  
Forest Practitioner Certification  
(Per CGS 23-65h)**

**ANDREW P CLARK**

**Certification Number SFPH000316**

**Expiration date: 03/01/2022**

A handwritten signature in black ink, appearing to read "Andrew P. Clark".

State Forester



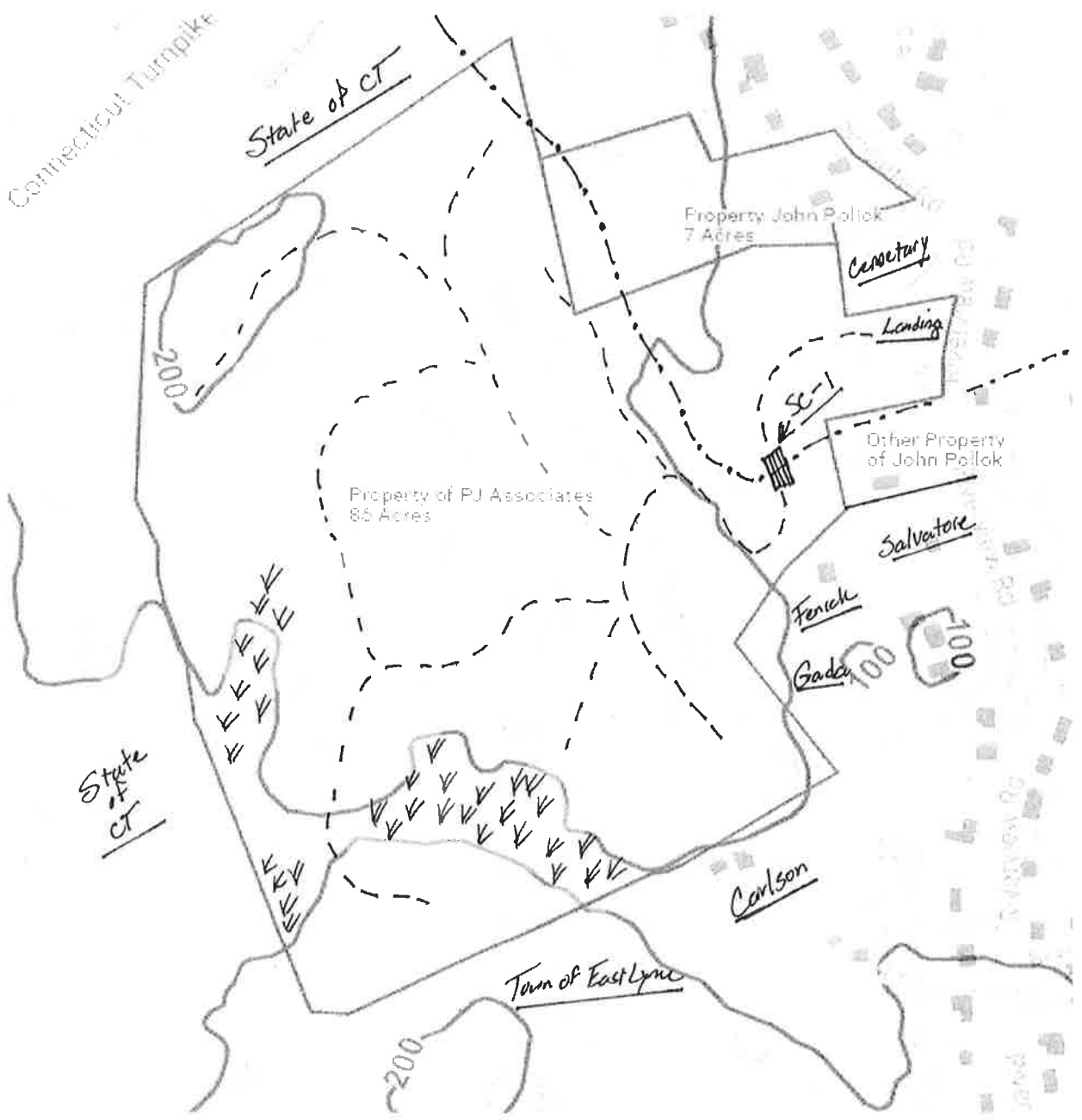

# TIMBER HARVEST MAP, PROPERTY OF PJ ASSOCIATES & JOHN POLLOK

MAP PREPARED BY ANDREW CLARK LICENSE # SFPH 000316

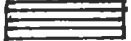

## LEGEND:

-  Property Line
-  Skid Trails
-  Perennial Stream
-  SCR-1 Bridged Stream Crossing



Wooded Forest Wetland

Scale: 1" = 500' +/-

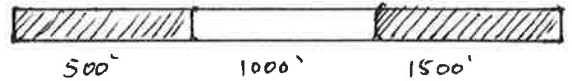



# TIMBER HARVEST MAP, PROPERTY OF PJ ASSOCIATES & JOHN POLLOK

MAP PREPARED BY ANDREW CLARK LICENSE # SFPH 000316

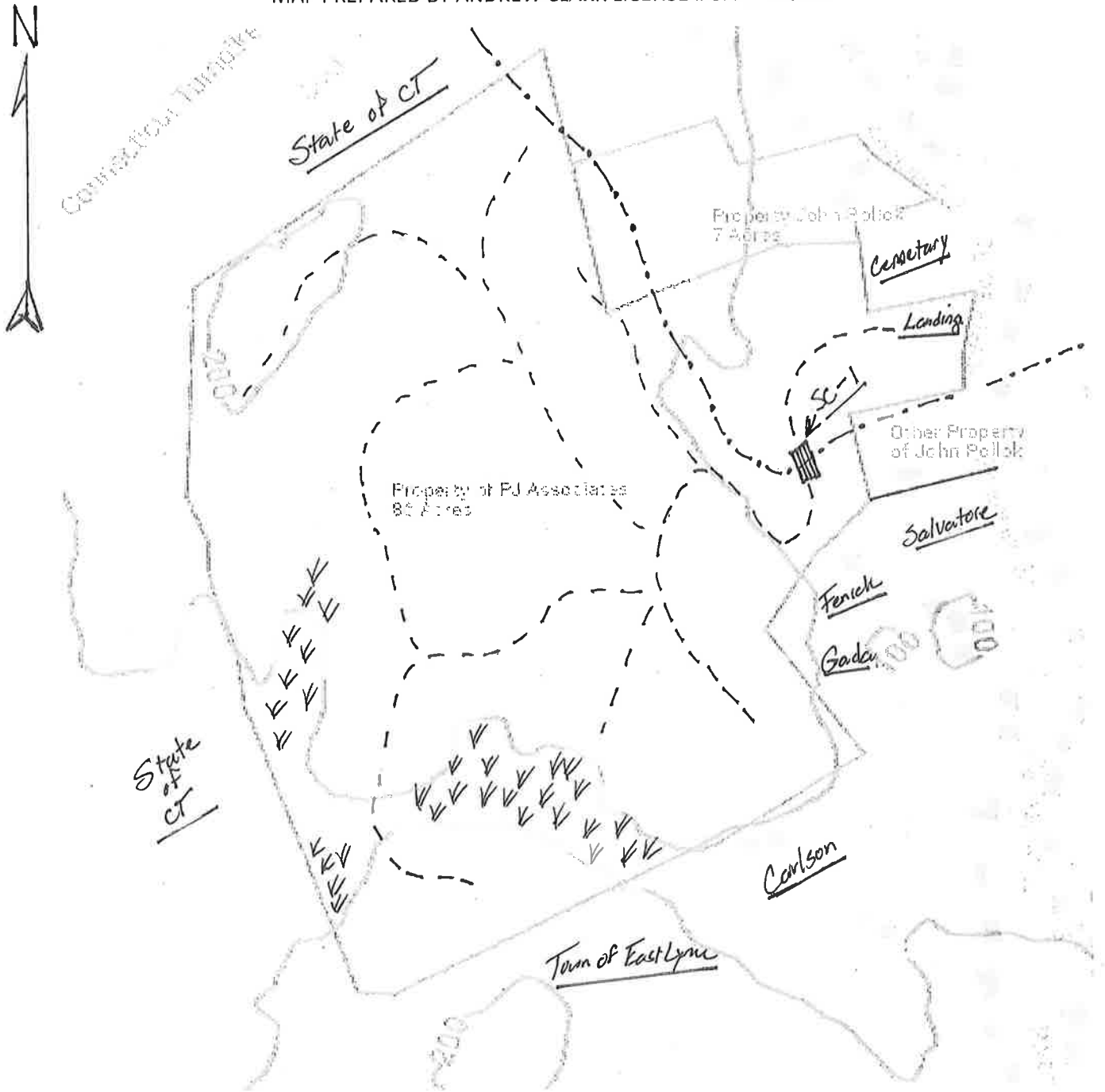

## LEGEND:

- Property Line
- - - - - Skid Trails
- · - · - Perennial Stream
- ▨▨▨▨▨ Scr-1 Bridged Stream Crossing



Wooded Forest Wetland

Scale: 1" = 500' +/-

