

Town of East Lyme

APPLICATION FOR SPECIAL PERMIT

Date of Application: 3/16/2021 Zone: _____

Applicant's Name: Scott O'Reilly, Owner, East Lyme Café, LLC dba Smokey O'Grady's

Applicant's Address: 306 Flanders Road East Lyme, CT 06333 Telephone: (860)

Location of Affected Premises: 306 Flanders Road Assessor's Map/Block/Lot: 31.3/7

Owner of Record: HW Properties LLC Volume/Page: 816/298

Owner's Address: 565 Coleman Street, New London, CT Telephone: _____

DESCRIPTION OF SPECIAL PERMIT REQUESTED {Requires compliance with Zoning Regulations 24, 25 & 9 and all other applicable Zoning Regulations of the Town of East Lyme; also state which sections of Zoning Regulations Special Permit is subject to}:

Renewal of Special Permit Application for Outdoor Dining at the above referenced premises with the following previously approved conditions:

- Entertainment will be allowed with acoustic guitar without amplification and a low level amplifier for the microphone only. Entertainment will be allowed until 10:00 p.m.;
- Service will be from 11:00 a.m. to 11:00 p.m., the last seating will be allowed at 10:00 p.m. All service shall cease at 11:00 p.m.;
- Upon request of the East Lyme Cemetery Association, any entertainment outside will be halted for burial services;
- There are to be 9 fixed seats around the service counter and 5 fixed seats around the tabletop and that will be serviced by wait staff;

Signature of Owner/Applicant: 

Attach a true copy of the Deed and a Site Plan {10 copies required}. A copy of the deeds for all affected properties and a site plan demonstrating compliance with all applicable zoning code requirements must accompany this application.

Proof of posting of Special Permit Application public notice sign (Section 25.4.3-1). Proof of posting of the Special Permit Application for Public Notice must be submitted.

Below this line for Office Use Only:

Deed Copies Attached:	YES	NO	PERMIT FEE: SPECIAL PERMIT FEE	\$150.00	_____	
			OUTDOOR DINING RENEWAL	\$20.00	20.00_	
Site Plan Attached:	YES	NO	N/A	SITE PLAN FEE	\$200.00	_____
				STORM WATER	\$200.00	_____
				STATE FEE:	\$60.00	_____
CHECK #:	<u>1729</u>		TOTAL DUE:	\$	<u>80.00</u>	

Date Approved: _____

Date Denied: _____

Approval subject to conditions below:

- _____
- _____

Approval to become effective upon publication and date of entry into the land records of the Town of East Lyme affecting the premises as described in this application.

Date: _____ Attest _____
East Lyme Zoning Chairman

Exh #1

UNDER BAR EQUIPMENT

- HAND SINK
- SUPREME METAL CHALLENGER CS-15-L
- 24 COCKTAIL UNIT
- SUPREME METAL CHALLENGER CS-16-24
- ICE BIN
- SUPREME METAL CHALLENGER CS-24

306 Flanders Road, Smokey O Grady's

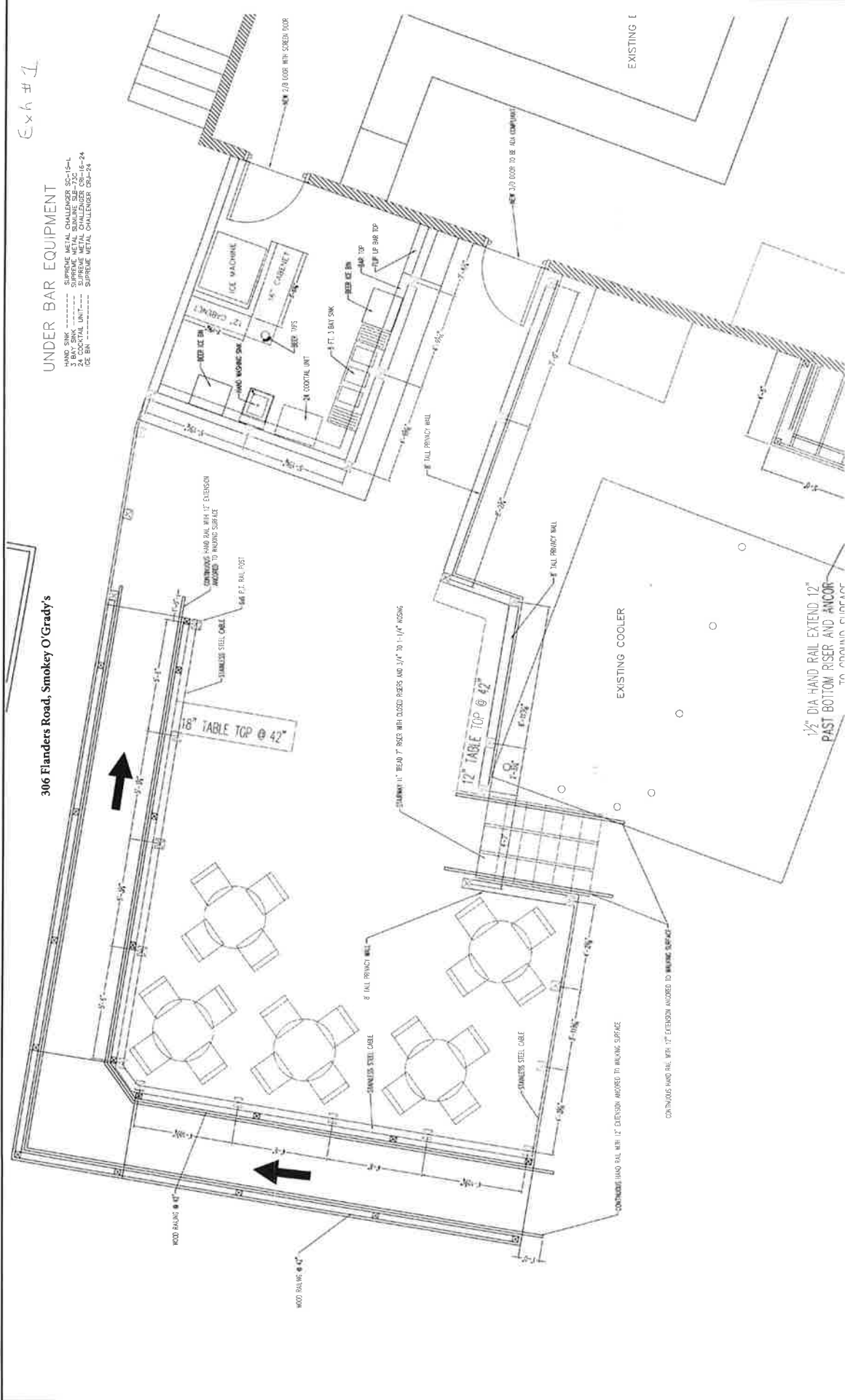

<p>DATE: March 22, 2007</p>	<p>DRAWN BY: ROP</p>	<p>DATE: March 22, 2007</p>	<p>SHEET NUMBER 4 of 5</p>
<p>J. ROBERT PFANNER & ASSOCIATES, P.C. CIVIL ENGINEERS & LAND SURVEYORS</p> <p>37 GRAND STREET NIANTIC, CONNECTICUT 06357 TEL. 860-739-6215 FAX 860-739-0695</p>		<p>SHEET TITLE: Deck Layout</p>	
<p>LOCATION: 306 Flanders Road East Lyme, Connecticut</p>		<p>SCALE: 1/2" = 1'-0"</p>	