

Town of East Lyme

APPLICATION FOR SPECIAL PERMIT

Date of Application: 3/16/2021 Zone: _____

Applicant's Name: Steve Carpenteri, Niantic Bay Inn, Inc dba Lyme Tavern

Applicant's Address: 229 W Main Street, Niantic, CT 06357 Telephone: (860) 625-7761

Location of Affected Premises: 229 W Main St Assessor's Map/Block/Lot: 10.3/1

Owner of Record: Niantic Bay Inn, Inc Volume/Page: 144/574

Owner's Address: 229 W Main St, Niantic CT 06357 Telephone: (860) 739-5631

DESCRIPTION OF SPECIAL PERMIT REQUESTED {Requires compliance with Zoning Regulations 24, 25 & 9 and all other applicable Zoning Regulations of the Town of East Lyme; also state which sections of Zoning Regulations Special Permit is subject to}:

Renewal of Special Permit Application for Outdoor Dining at the above referenced premises with the following previously approved conditions:

- A. Acoustic Outdoor entertainment only with no amplification
- B. May have speakers of low volume
- C. Last seating at 11:00 p.m., area cleared by midnight
- D. Lighting must be minimal and turned off at close of business
- E. 1 year permit

Signature of Owner/Applicant: _____

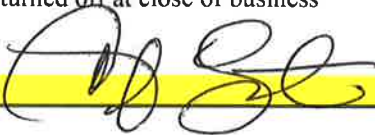

Attach a true copy of the Deed and a Site Plan {10 copies required}. A copy of the deeds for all affected properties and a site plan demonstrating compliance with all applicable zoning code requirements must accompany this application.

Proof of posting of Special Permit Application public notice sign (Section 25.4.3-1). Proof of posting of the Special Permit Application for Public Notice must be submitted.

Below this line for Office Use Only:

Deed Copies Attached:	YES	NO	PERMIT FEE: SPECIAL PERMIT FEE	\$150.00	_____
			OUTDOOR DINING RENEWAL	\$20.00	<u>\$20.00</u>
Site Plan Attached:	YES	NO	N/A	SITE PLAN FEE	\$200.00 _____
				STORM WATER	\$200.00 _____
				STATE FEE:	\$60.00
CHECK #:	<u>11009</u>		TOTAL DUE:	\$	<u>\$80.00</u>

Date Approved: _____ Date Denied: _____

Approval subject to conditions below:

1. _____
2. _____

Approval to become effective upon publication and date of entry into the land records of the Town of East Lyme affecting the premises as described in this application.

Date: _____ Attest _____
East Lyme Zoning Chairman

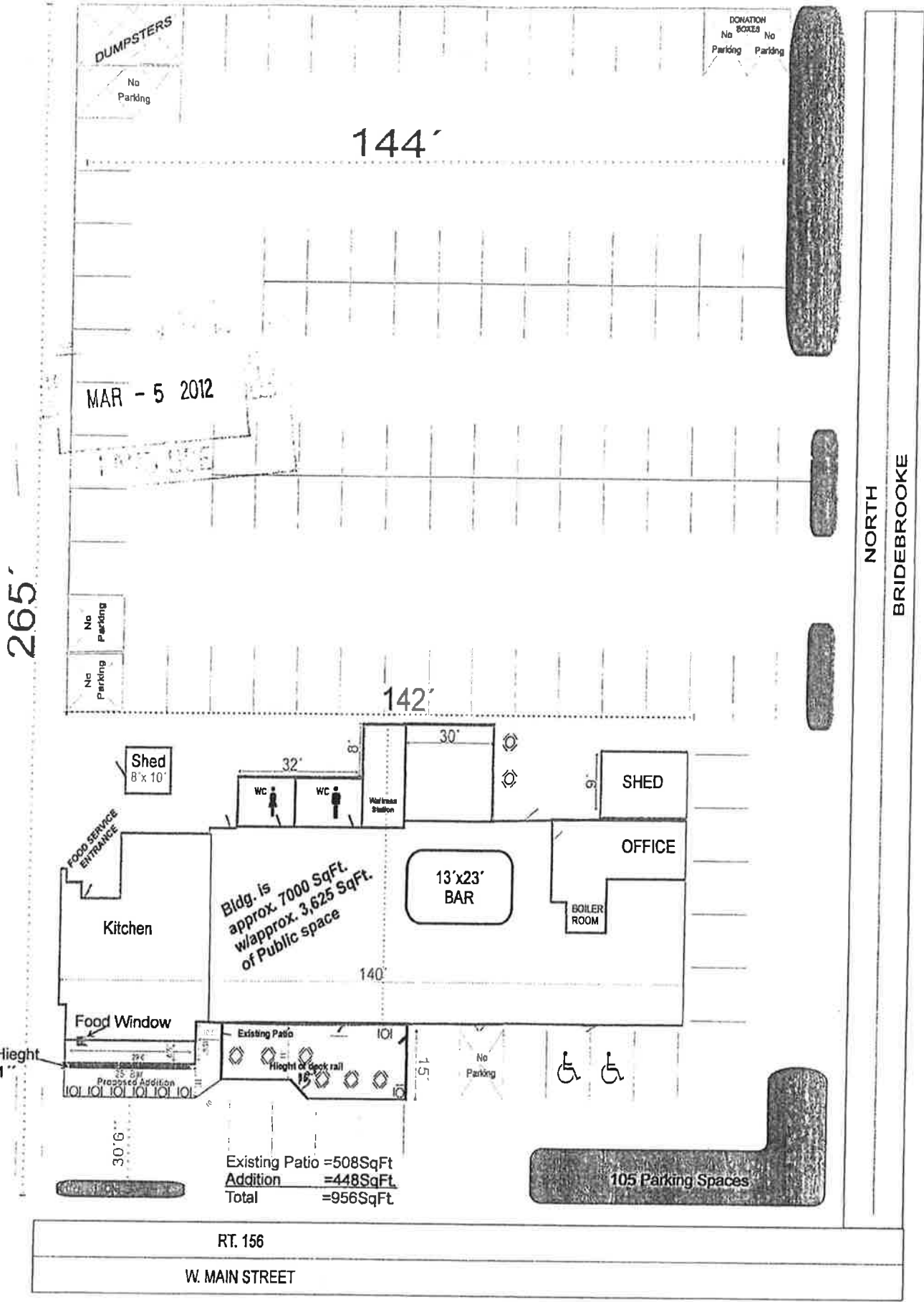

Existing Patio = 508 SqFt
 Addition = 448 SqFt
 Total = 956 SqFt

Assessor's Map 10.3 lot1
 38,160 SqFt

LYME TAVERN
 229 WEST MAIN STREET
 NIAHTIC, CT 06357
 (860) 739-5631

Not Drawn to scale
 March 5, 2012

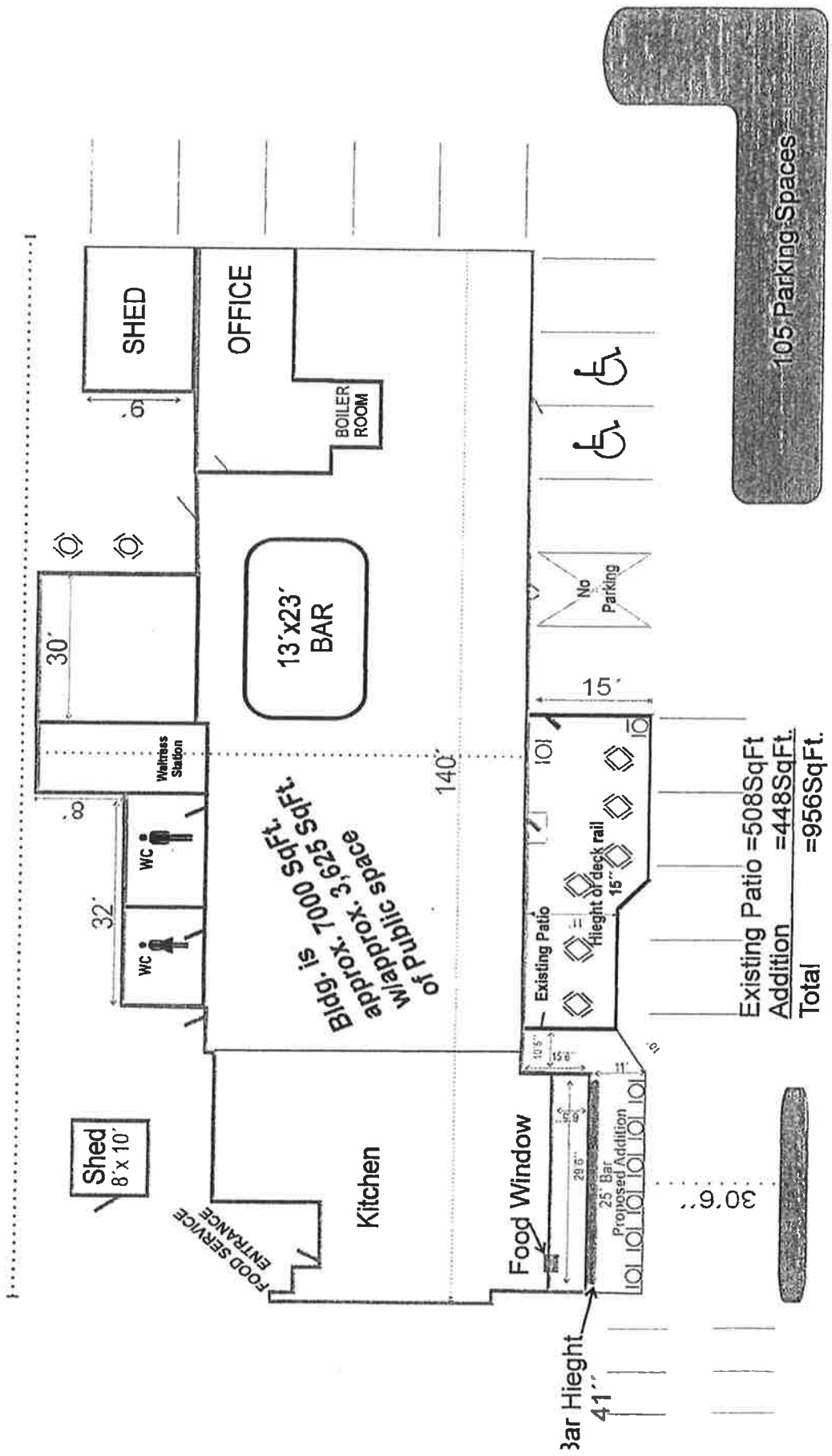

Bldg. is approx. 700 SqFt.
w/ approx. 3,625 SqFt. of public space

Existing Patio = 508 SqFt
Addition = 448 SqFt.
Total = 956 SqFt.

RT. 156
W. MAIN STREET

Assessor's Map 10.3 lot1
38,160 SqFt

LYME TAVERN
229 WEST MAIN STREET
NIANTIC, CT 06357
(860) 739-5631

Not Drawn to scale
March 5, 2012