

Town of East Lyme

APPLICATION FOR SPECIAL PERMIT

Date of Application: 3/16/2021 Zone: _____

Applicant's Name: Eduardo Martone

Applicant's Address: 70 Barbara Lane Plantsville CT 06479
350 Brownstone Ridge, Meriden, CT 06451 Telephone: (203)631-4312

Location of Affected Premises: 11 E Pattagansett Rd Assessor's Map/Block/Lot: 11.2/150

Owner of Record: Darm & K LLC Volume/Page: 944/301

Owner's Address: same as above Telephone: (203) 631-4312

DESCRIPTION OF SPECIAL PERMIT REQUESTED *{Requires compliance with Zoning Regulations 24, 25 & 9 and all other applicable Zoning Regulations of the Town of East Lyme; also state which sections of Zoning Regulations Special Permit is subject to}*:

Renewal of Special Permit Application for Outdoor Dining at the above referenced premises with the following previously approved conditions:

- A. No outdoor entertainment is allowed
- B. Last seating on weekdays is at 8:00 p.m., outdoor patio to close at 9:00 p.m.
- C. Last seating on weekends is at 9:00 p.m., outdoor patio to close at 10:00 p.m.
- D. Low level speakers allowed for background dining music.
- E. 1 year permit

Signature of Owner/Applicant: 

Attach a true copy of the Deed and a Site Plan {10 copies required}. A copy of the deeds for all affected properties and a site plan demonstrating compliance with all applicable zoning code requirements must accompany this application.

Proof of posting of Special Permit Application public notice sign (Section 25.4.3-1). Proof of posting of the Special Permit Application for Public Notice must be submitted.

Below this line for Office Use Only:

Deed Copies Attached:	YES	NO		PERMIT FEE: SPECIAL PERMIT FEE	\$150.00	_____
				OUTDOOR DINING RENEWAL	\$20.00	<u>\$20.00</u>
Site Plan Attached:	YES	NO	N/A	SITE PLAN FEE	\$200.00	_____
				STORM WATER	\$200.00	_____
				STATE FEE:		\$60.00
CHECK #:	<u>3015</u>			TOTAL DUE:		\$ <u>\$80.00</u>

Date Approved: _____ Date Denied: _____

Approval subject to conditions below:

1. _____
2. _____

Approval to become effective upon publication and date of entry into the land records of the Town of East Lyme affecting the premises as described in this application.

Date: _____ Attest _____
 East Lyme Zoning Chairman

PATIO SEATING w/ Fencing w/ RAIL.

11 East Pattagansett Road; Costello's

- 1 - Pic white Fencing
- 2-7 - outside seats
- 8-13 - Umbrellas
- 14 - Gate/Door
- 15 - Railings?

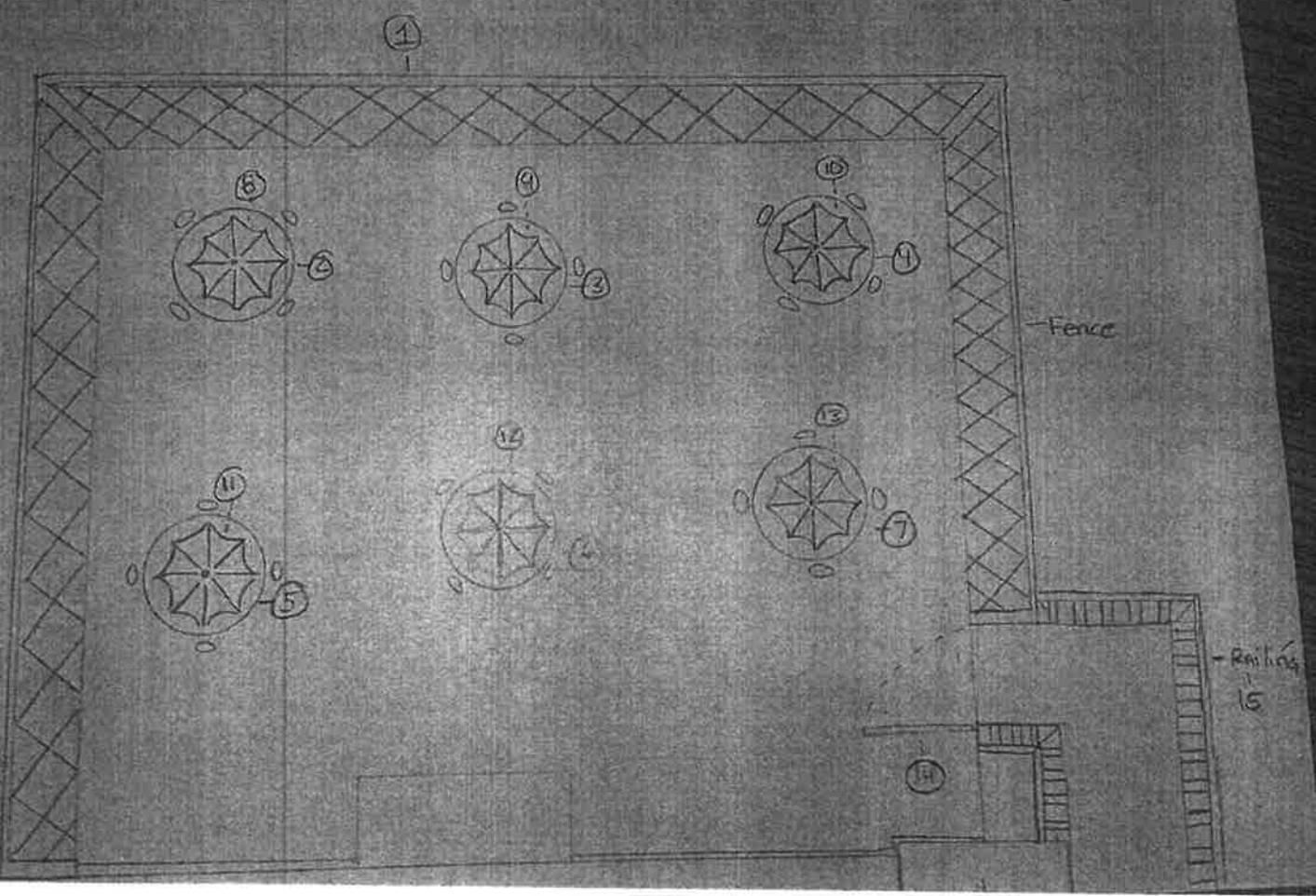

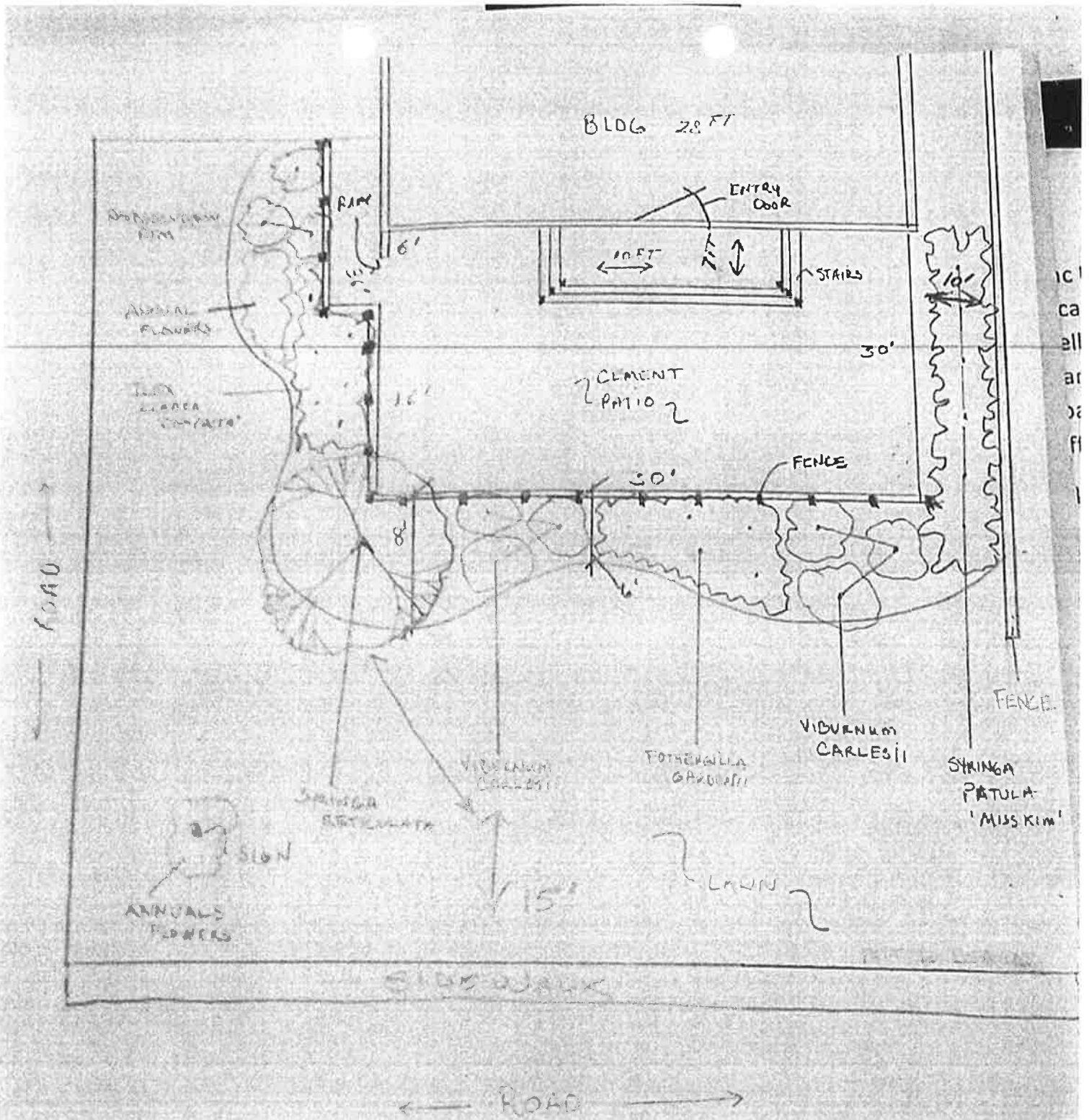

PLANT LIST

- Knobelkandon BSM
- Tree - Ilex glabra compacta
- Shrub - Fothergilla - Fothergilla gardenii
- Shrub - Viburnum - Viburnum carlesii
- Shrub - Fothergilla - Fothergilla gardenii
- Shrub - Stronga - Stronga patula 'Miss Kim'
- Annual flowers

